

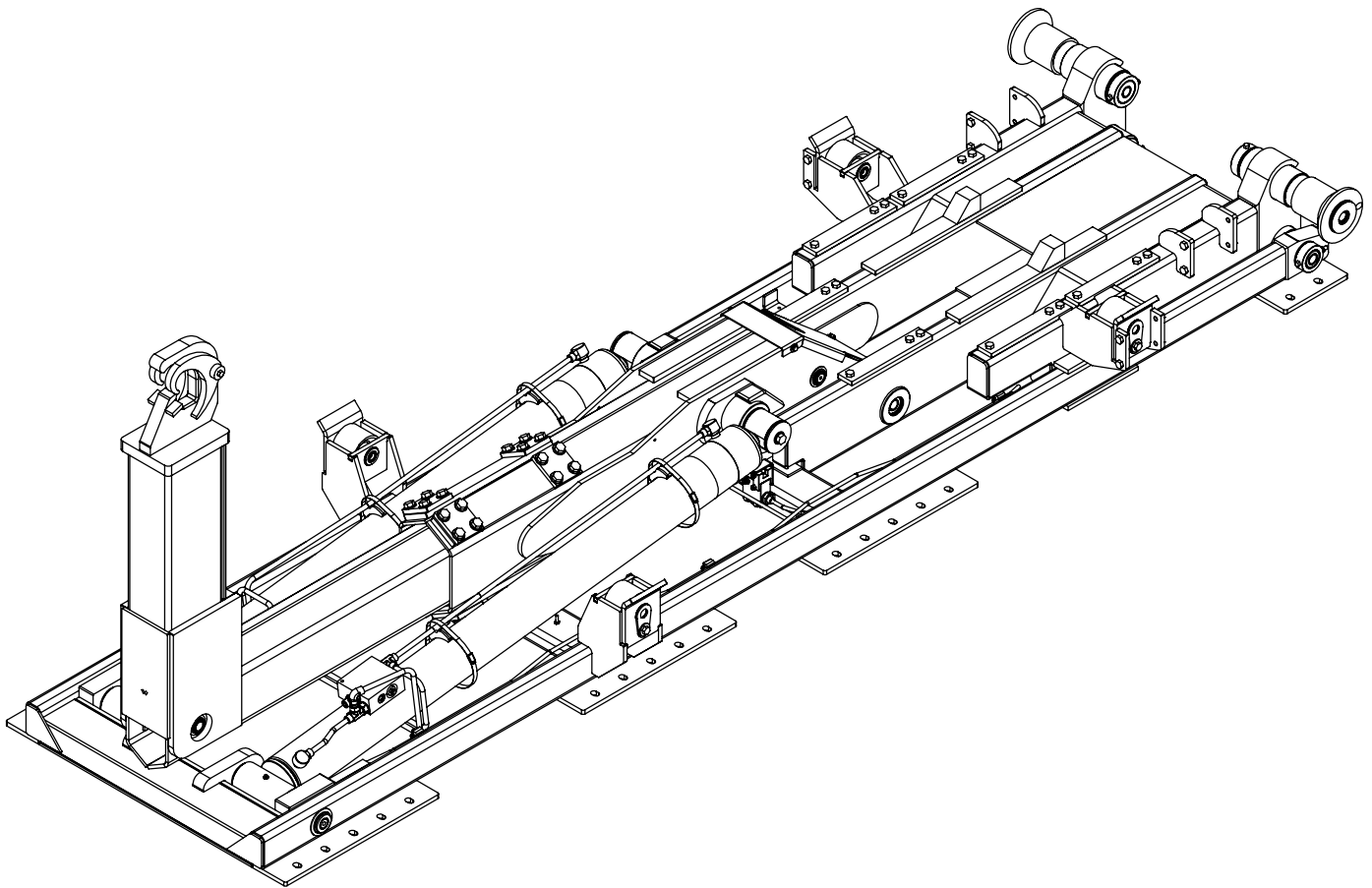

# Slider20-S Hooklift Owner's Manual

Installation • Assembly Drawings • Parts



**Stellar Industries, Inc.**

**190 State Street**

**PO Box 169**

**Garner, IA 50438**

**800-321-3741**

**Fax: 641-923-2811**

**[www.stellarindustries.com](http://www.stellarindustries.com)**

Subject to Change without Notification.  
© 2016 Stellar Industries, Inc.

Last Revision: 11/04/16



# Table of Contents

|  |           |
|--|-----------|
| Introduction   | iv        |
| Serial Tag Location                                      | v         |
| <b>Chapter 1 - Specifications</b>                        | <b>1</b>  |
| Slider20-S Specifications                                | 1         |
| Slider20-S Latch Locations for Skid Compatibility        | 2         |
| Slider20-S Grease Zerk Locations                         | 2         |
| <b>Chapter 2 - Installation</b>                          | <b>3</b>  |
| General Installation                                     | 3         |
| Installer Notice   | 3         |
| Torque Data Chart  | 4         |
| Installation Note  | 5         |
| Step 1: Set the hooklift onto the truck frame            | 5         |
| Step 2: Drill mounting holes                             | 5         |
| Step 3: Install bumper                                   | 6         |
| Step 4: Install tie-downs                                | 6         |
| Step 5: Install tarper tower (If applicable)             | 6         |
| Step 6: Install hydraulic reservoir and valve bank       | 6         |
| Reservoir Assembly (2 Section Cable Controls) - PN 70524 | 7         |
| Reservoir Assembly (3 Section Cable Controls) - PN 70523 | 8         |
| Reservoir Assembly (2 Section Air Controls) - PN 70522   | 9         |
| Reservoir Assembly (3 Section Air Controls) - PN 70524   | 10        |
| Valve Bank Parts Drawing                                 | 11        |
| Step 7: Install PTO and pump                             | 12        |
| Face Seal/O-Ring Size Chart                              | 13        |
| Step 8: Route hydraulic hoses                            | 13        |
| Hose Kit - PN 54851 (Fixed Hook Height Models)           | 14        |
| Hose Kit - PN 84189 (Adjustable Hook Height Models)      | 15        |
| Power Beyond VDM8 Valve                                  | 16        |
| Port Side Relief Installation                            | 17        |
| Step 9: Route Electrical Components                      | 18        |
| Step 10: Install cab and PTO controls                    | 19        |
| Cable Controls   | 19        |
| Air Controls   | 20        |
| Optional - Controller Pedestal Reinforcement             | 21        |
| Step 11: Install mud flaps and fenders                   | 22        |
| Step 12: Install Hoist Up Light Sensor - PN 83115        | 22        |
| Step 13: Apply Decals                                    | 23        |
| Step 14: Fill reservoir and activate hydraulic flow      | 24        |
| Step 15: Operate hooklift                                | 24        |
| Set System Relief Pressure                               | 24        |
| <b>Chapter 3 - Assembly Drawings</b>                     | <b>25</b> |
| Base Assembly - PN 65658                                 | 25        |
| Plunger Valve Assembly - PN 86130                        | 25        |
| Dump Assembly - PN 68957                                 | 27        |
| Outside Latch Assembly - PN 55358 (Optional)             | 28        |
| Inside Latch Assembly - PN 54216 (Optional)              | 29        |
| Secondary Assembly - PN 66661                            | 30        |
| Dump Latch Assembly - PN 80982                           | 31        |
| Main Cylinder Assembly - PN 66826                        | 32        |
| Jib Assembly (35.63" Hook Height) - PN 66657             | 33        |
| Jib Assembly (54" Hook Height) - PN 68298                | 34        |
| Jib Assembly (35.63/54" Hook Height) - PN 66583          | 35        |
| Hose Track - PN 54213                                    | 37        |
| Slider20-S Cylinder Assemblies                           | 38        |
| Toolbox Assembly - PN 8480                               | 39        |
| Toolbox Assembly - PN 10401                              | 39        |
| Toolbox Assembly - PN 10402                              | 39        |

# Introduction

A copy of this manual is provided with every hooklift and can be found in the hard plastic manual case that is installed on the chassis. A copy of this manual shall remain with the hooklift at all times.

Throughout the manual, three signal words will be used to bring attention to important items:

## **NOTICE**

A NOTICE signal word indicates a practice not related to physical injury.

## **⚠ WARNING**

A WARNING signal word indicates a hazardous situation which, if not avoided, could result in death or serious injury.

## **⚠ DANGER**

A DANGER signal word indicates a hazardous situation which, if not avoided, will result in death or serious injury.

Information contained within this manual does not cover operation, maintenance, or troubleshooting. Please refer to the General Slider Hooklift Manual for details on these items.

This manual is not binding. Stellar Industries, Inc. reserves the right to change, at any time, any or all of the items, components, and parts deemed necessary for product improvement or commercial/production purposes. This right is kept with no requirement or obligation for immediate mandatory updating of this manual.

In closing:

If more information is required or technical assistance is needed, or if you feel that any part of this manual is unclear or incorrect, please contact the Stellar Customer Service Department by phone at 800-321-3741 or email at [service@stellarindustries.com](mailto:service@stellarindustries.com).

**For Technical Questions, Information, Parts, or Warranty, Call Toll-Free at  
800-321-3741**

Hours: Monday - Friday, 8:00 a.m. - 5:00 p.m. CST

Or email at the following addresses:

**Technical Questions, and Information**

[service@stellarindustries.com](mailto:service@stellarindustries.com)

**Order Parts**

[parts@stellarindustries.com](mailto:parts@stellarindustries.com)

**Warranty Information**

[warranty@stellarindustries.com](mailto:warranty@stellarindustries.com)

# Serial Tag Location

The serial tag should be located on the right side (passenger side) of the base assembly:

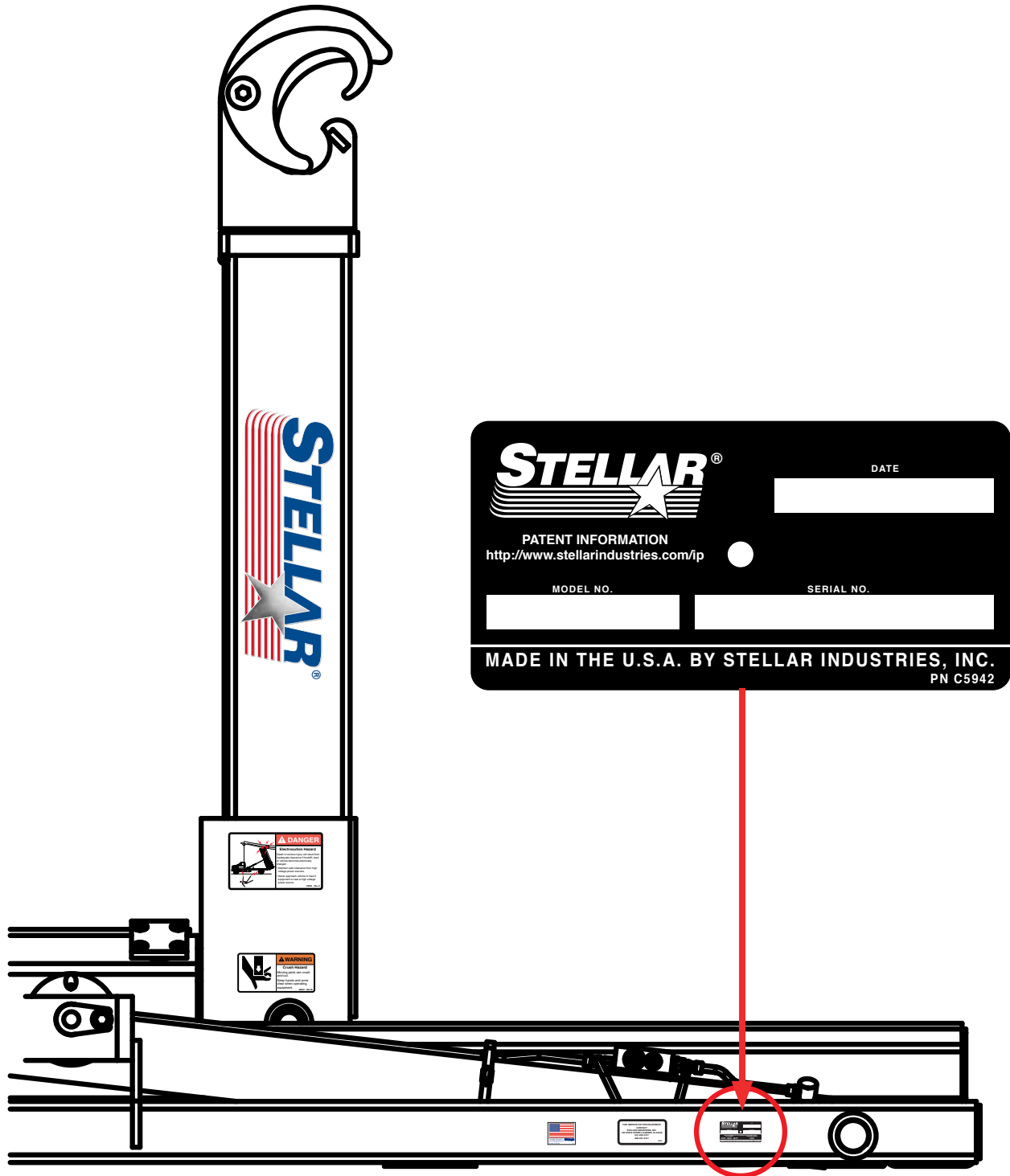

**This page intentionally left blank.**

# Chapter 1 - Specifications

## Slider20-S Specifications

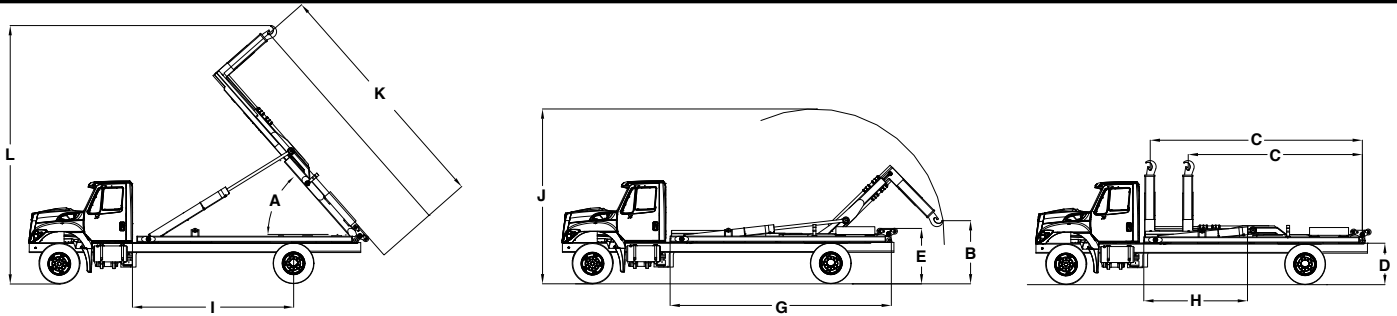

|                                   | 35.63" (905mm) Fixed Hook Height          | 54" (1,372mm) Fixed Hook Height           | 35.63" (905mm) to 54" (1,372mm) Hydraulic Adjustable |
|-----------------------------------|---|---|--|
| Lifting Capacity                  | 20,000 lbs (9,072 kg)                     | 20,000 lbs (9,072 kg)                     | 20,000 lbs (9,072 kg)                                |
| Dumping Capacity                  | 20,000 lbs (9,072 kg)                     | 20,000 lbs (9,072 kg)                     | 20,000 lbs (9,072 kg)                                |
| A Dump Angle                      | 60°                                       | 60°                                       | 60°  |
| B Lowest Hook Height              | 28.5" (724 mm)                            | 8.63" (219 mm)                            | 8.63" or 28.5" (219 mm or 724 mm)                    |
| C Effective Length                | 112.50" to 142.50" (2,858 mm to 3,620 mm) | 112.50" to 142.50" (2,858 mm to 3,620 mm) | 112.50" to 142.50" (2,858 mm to 3,620 mm)            |
| D Truck Frame Height              | 40" (1,016 mm)                            | 40" (1,016 mm)                            | 40" (1,016 mm)                                       |
| E Hooklift Height                 | 51.88" (1,318 mm)                         | 51.88" (1,318 mm)                         | 51.88" (1,318 mm)                                    |
| G Hooklift Length                 | 152.13" (3,865 mm)                        | 152.13" (3,865 mm)                        | 152.13" (3,865 mm)                                   |
| H Hooklift Center of Gravity      | 70" (1,778 mm)                            | 68" (1,727 mm)                            | 67.75" (1,721 mm)                                    |
| I Chassis Cab to Axle             | 108" to 120" (2,743 mm to 3,048 mm)***    | 108" to 120" (2,743 mm to 3,048 mm)***    | 108" to 120" (2,743 mm to 3,048 mm)***               |
| J Max. Height When Loading        | 129" (3,276 mm)                           | 142.6" (3,622 mm)                         | 129" to 142.6" (3,276 mm to 3,622 mm)                |
| K Longest Body When Dumping       | 15'                                       | 15'                                       | 15'  |
| L Max. Height When Dumping        | 196" (4,979 mm)                           | 206.50" (5,245 mm)                        | 196" to 206.50" (4,979 mm to 5,245 mm)               |
| Maximum Operating Pressure        | 4,500 psi (31 MPa)                        | 4,500 psi (31 MPa)                        | 4,500 psi (31 MPa)                                   |
| Hydraulic Flow                    | 25 gpm (95 lpm)                           | 25 gpm (95 lpm)                           | 25 gpm (95 lpm)                                      |
| Shipping Weight                   | 2,800 lbs (1,270 kg)                      | 2,880 lbs (1,305 kg)                      | 2,910 lbs (1,320 kg)                                 |
| Shipping Dimensions (LxWxH)       | 152.13" x 46" x 58"                       | 152.13" x 46" x 76"                       | 152.13" x 46" x (58-76")                             |
| Minimum Truck GVWR                | 25,000 lbs (11,340 kg)                    | 25,000 lbs (11,340 kg)                    | 25,000 lbs (11,340 kg)                               |
| Load Angle w/Shortest Body Length | 60°                                       | 55°                                       | 55°  |
| Recommended Container Lengths*    | 10' to 14' (4,267 mm to 4,877 mm)         | 10' to 14' (4,267 mm to 4,877 mm)         | 10' to 14' (4,267 mm to 4,877 mm)                    |
| Recommended Flatbed Lengths**     | Up to 16' (4,877 mm)                      | Up to 16' (4,877 mm)                      | Up to 16' (4,877 mm)                                 |

\*Assumes 3 ft. overhang from center of rear roller pin (Bumper typically 12" from center of roller pin)

\*\*Assumes 5 ft. overhang from center of rear roller pin (May require bumper and latch options)

\*\*\*Weight Distribution Required

# Slider20-S Latch Locations for Skid Compatibility

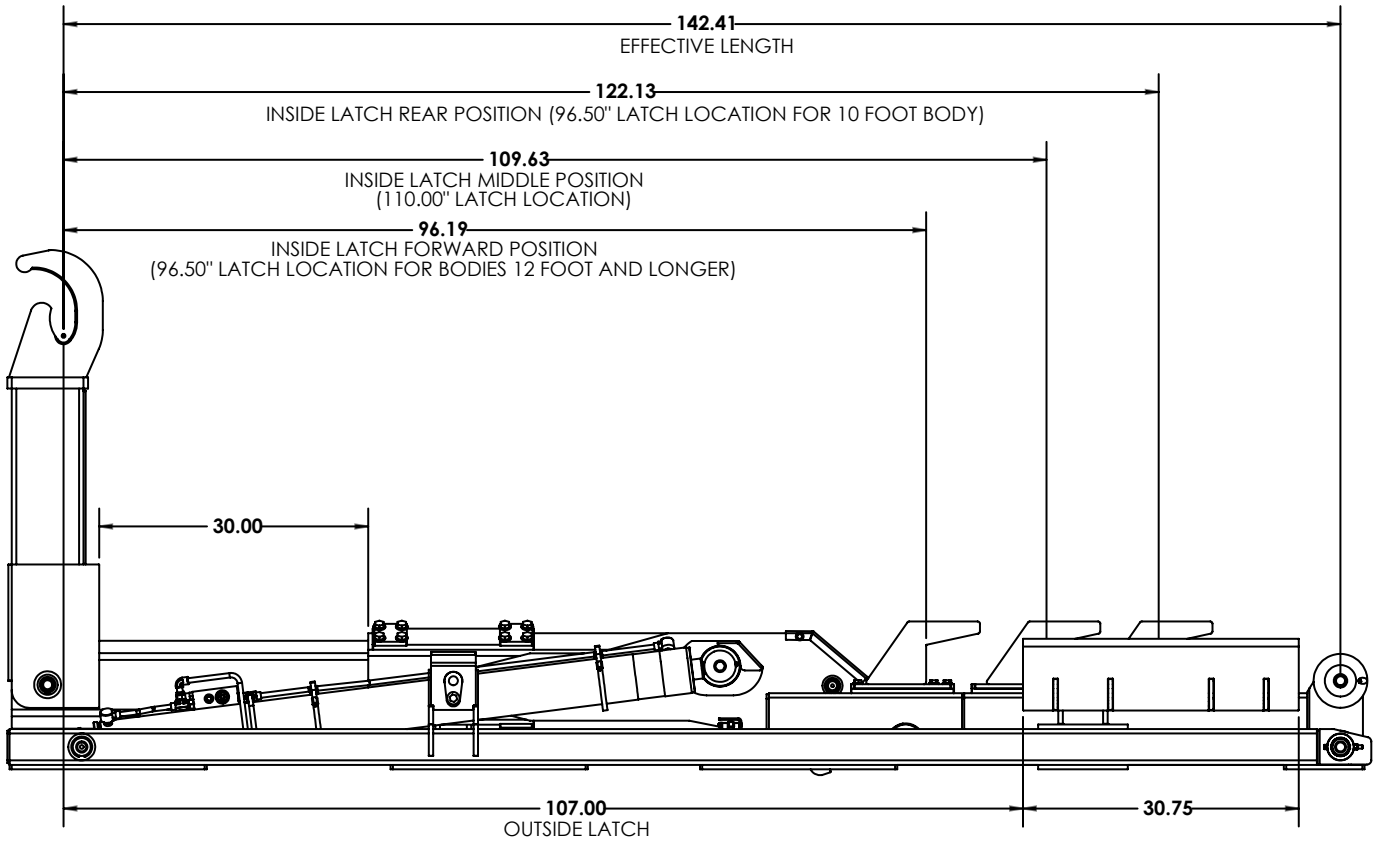

# Slider20-S Grease Zerk Locations

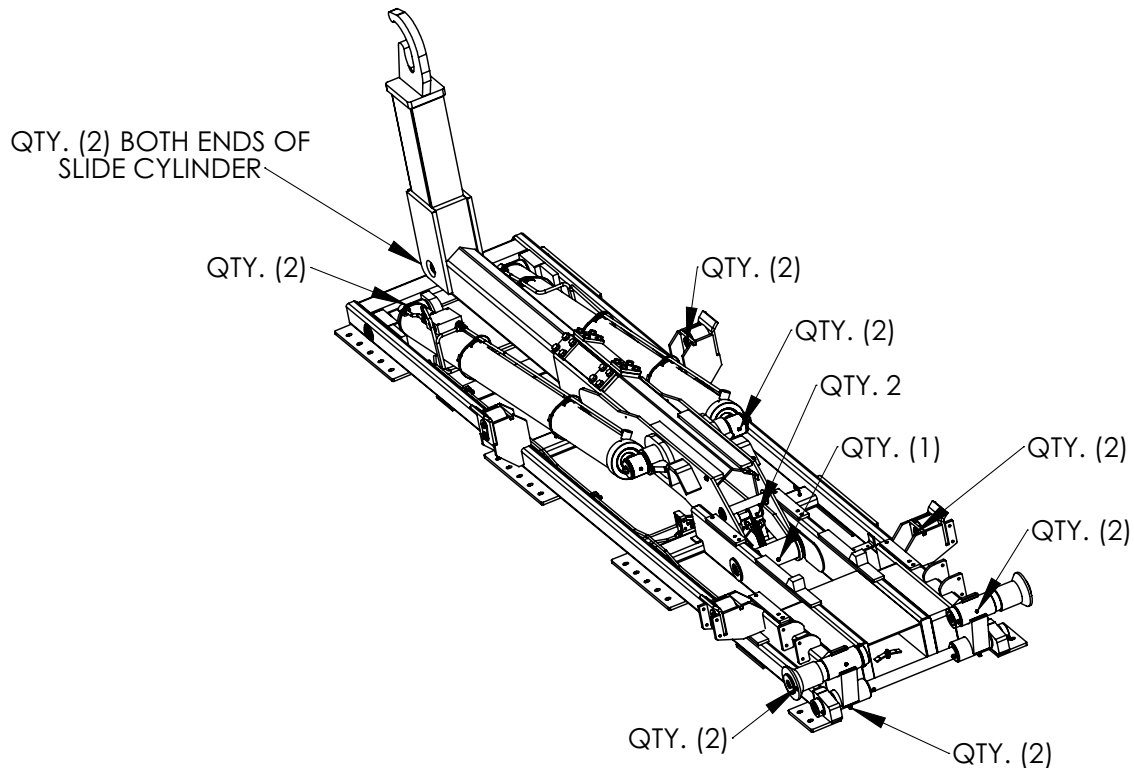

**Note: Grease After Every 100 Cycles.**



# Chapter 2 - Installation

## General Installation

This chapter is designed to serve as a general guide for the installation of a Stellar® Slider20S Hooklift. Each installation is considered unique so certain portions of this chapter may or may not apply to your direct application. If a question should arise during the installation process, please contact Stellar Customer Service at (800) 321 3741.

PTO and Pump installation instructions are provided by the corresponding manufacturers. For more information on which PTO and Pump fit your application, please contact your local Stellar Distributor or Stellar Customer Service.

**⚠ WARNING** Do not install this hooklift on a chassis not capable of handling the loads imposed on it. Failure to do so may result in serious injury or death.

**NOTICE** Do not weld or drill holes into the side wall of the base tubes.

### Hooklift Mounting and Assembly

Study names and locations of the parts and familiarize yourself with the hooklift before starting the assembly. Reading the step-by-step instructions that follow will be helpful.

#### Assembly

Select an area for assembly that will be large enough to accommodate the completed unit. The surface of the work area should be as level as possible. Use the proper hand tools to ensure proper bolt tightness. Refer to the torque data chart in this chapter for the recommended torque values for different sizes of bolts.

#### Model Number

Know the model number of the Stellar® Hooklift being mounted. Use this model number whenever referring to the assembly or parts listing pages. The number is stamped on the name plate which is located on the front frame member.

## Installer Notice

According to Federal Law (49 cfr part 571), each final-stage manufacturer shall complete the vehicle in such a manner that it conforms to the standards in effect on the date of manufacture of the incomplete vehicle, the date of final completion, or a date between those two dates. This requirement shall, however, be superseded by any conflicting provisions of a standard that applies by its terms to vehicles manufactured in two or more stages.

Therefore, the installer of Stellar® Hooklifts is considered one of the manufacturers of the vehicle. As such a manufacturer, the installer is responsible for compliance with all applicable federal and state regulations. They are required to certify that the vehicle is in compliance with the Federal Motor Vehicle Safety Standards and other regulations issued under the National Traffic and Motor Vehicle Safety Act.

Please reference the Code of Federal Regulations, title 49 - Transportation, Volume 5 (400-999), for further information, or visit <http://www.gpoaccess.gov/nara/index.html> for the full text of Code of Federal Regulations.

## Torque Data Chart

When using the torque data in the chart, the following rules should be observed:

- Bolt manufacturer's particular specifications should be consulted when provided.
- Flat washers of equal strength must be used.
- All torque measurements are given in foot-pounds. To convert to inch-pounds, multiply by 12.
- Torque values specified are for bolts with residual oils or no special lubricants applied. If special lubricants of high stress ability, such as Never-Seez compound graphite and oil, molybdenum disulphite, colloidal copper or white lead are applied, multiply the torque values in the charts by the factor .90. The use of Loctite does not affect the torque values listed above.

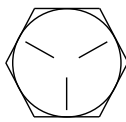
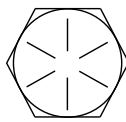
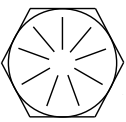
|                |                   | GRADE 5  |                | GRADE 8   |                | GRADE 9   |
|----------------|-------------------|--|----------------|---|----------------|---|
|                |                   |  |                |  |                |  |
| Size (DIA-TPI) | Bolt DIA (Inches) | Plain (Ft-Lb)  | Plated (Ft-Lb) | Plain (Ft-Lb)   | Plated (Ft-Lb) | Plated (Ft-Lb)  |
| 5/16-18        | 0.3125            | 17   | 13             | 25  | 18             | 22  |
| 3/8-16         | 0.3750            | 31   | 23             | 44  | 33             | 39  |
| 7/16-14        | 0.4375            | 49   | 37             | 70  | 52             | 63  |
| 1/2-13         | 0.5000            | 75   | 57             | 105   | 80             | 96  |
| 9/16-12        | 0.5625            | 110  | 82             | 155   | 115            | 139   |
| 5/8-11         | 0.6250            | 150  | 115            | 220   | 160            | 192   |
| 3/4-10         | 0.7500            | 265  | 200            | 375   | 280            | 340   |
| 7/8-9          | 0.8750            | 395  | 295            | 605   | 455            | 549   |
| 1-8            | 1.000             | 590  | 445            | 910   | 680            | 823   |
| 1 1/8-7        | 1.1250            | 795  | 595            | 1290  | 965            | 1167  |
| 1 1/4-7        | 1.2500            | 1120   | 840            | 1815  | 1360           | 1646  |
| 1 3/8-6        | 1.3750            | 1470   | 1100           | 2380  | 1780           | 2158  |
| 1 1/2-6        | 1.500             | 1950   | 1460           | 3160  | 2370           | 2865  |

- Torque values for socket-head capscrews are the same as for Grade 8 capscrews.
- Do not use these values if a different torque value or tightening procedure is given for a specific application. Torque values listed are for general use only. Check tightness of fasteners periodically.
- Sheer bolts are designed to fail under predetermined loads. Always replace shear bolts with identical grade.
- Fasteners should be replaced with the same or higher grade. If higher grade fasteners are used, these should only be tightened to the strength of the original.
- Tighten plastic insert or crimped steel-type lock nuts to approximately 110 percent of the dry torque values shown in the chart below, applied to the nut, not to the bolt head. Tighten toothed or serrated-type lock nuts to the full torque value. *Note: "Lubricated" means coated with a lubricant such as engine oil, or fasteners with phosphate and oil coatings. "Dry" means plain or zinc plated without lubrication. Tighten lubricated bolts to approximately 80% of dry bolts.*

## Installation Note

Every hooklift installation is unique. However, certain guidelines exist that apply to every model. Listed below is a general set of chronological steps that may be followed when installing a Stellar Hooklift. If any questions arise during the installation process, feel free to contact your local dealer or Stellar Customer Service at 800-321-3741.

### Step 1: Set the hooklift onto the truck frame.

- Visually inspect the truck and look for any potential issues. For example: Clearance problems, cross members extending too high, insufficient room in front of the Slider for tarpers, exhaust manifolds, etc., or insufficient room in the rear to allow for bumper selection. *Note: Stellar Industries recommends allowing 12" behind the start of clear truck frame for installation of a tarping system.*
- Be sure to square the Slider on the truck frame to allow for proper measurement. The front of the hooklift needs to be at least 2.50" behind the cab or any equipment mounted behind the cab. *Note: On some Slider models, the jib may extend beyond the front of the base.*

### Step 2: Drill mounting holes.

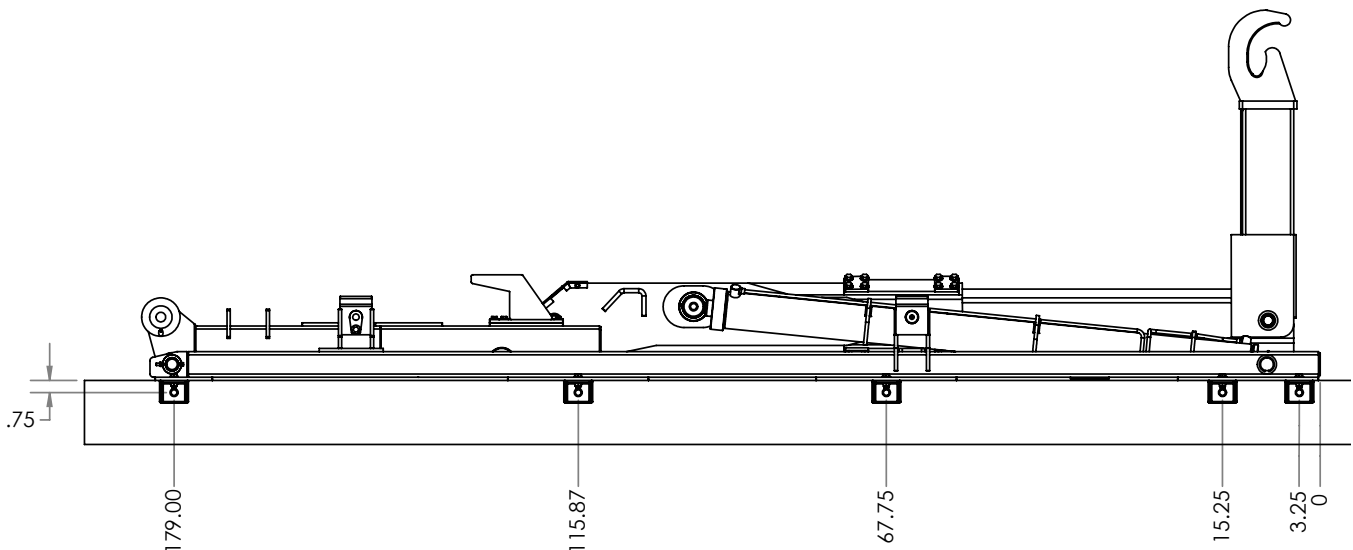

Note: These are approximate measurements from the front of the hooklift base. Specific applications may vary.

- When positioning mounts to frame, tie-down castings are bolted to the underside of each tie down plate located on the outside of the main rails of the base. The tie-down plate closest to the front of the base requires one mount on each side of the pin. This is the only time two tie down castings are required per a single tie-down plate. The tie-down plates are designed with multiple slots to offer more flexibility in mounting locations. Additional holes may not be added to the tie-down plates.
- Using the tie-down castings as a guide, drill 11/16" holes through the truck frame as shown.

## Step 3: Install bumper.

- See NHTSA (National Highway Truck Safety Administration) Regulations for acceptable placement.
- Modify the truck frame as necessary so that it ends 2" from the rear of the hooklift.

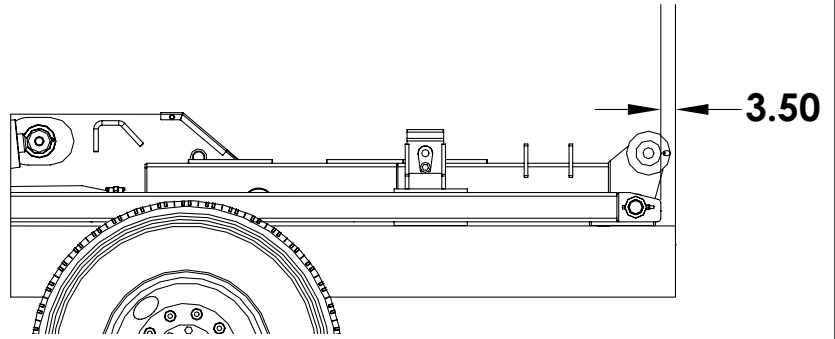

## Step 4: Install tie-downs.

Note: See torque chart at beginning of chapter:

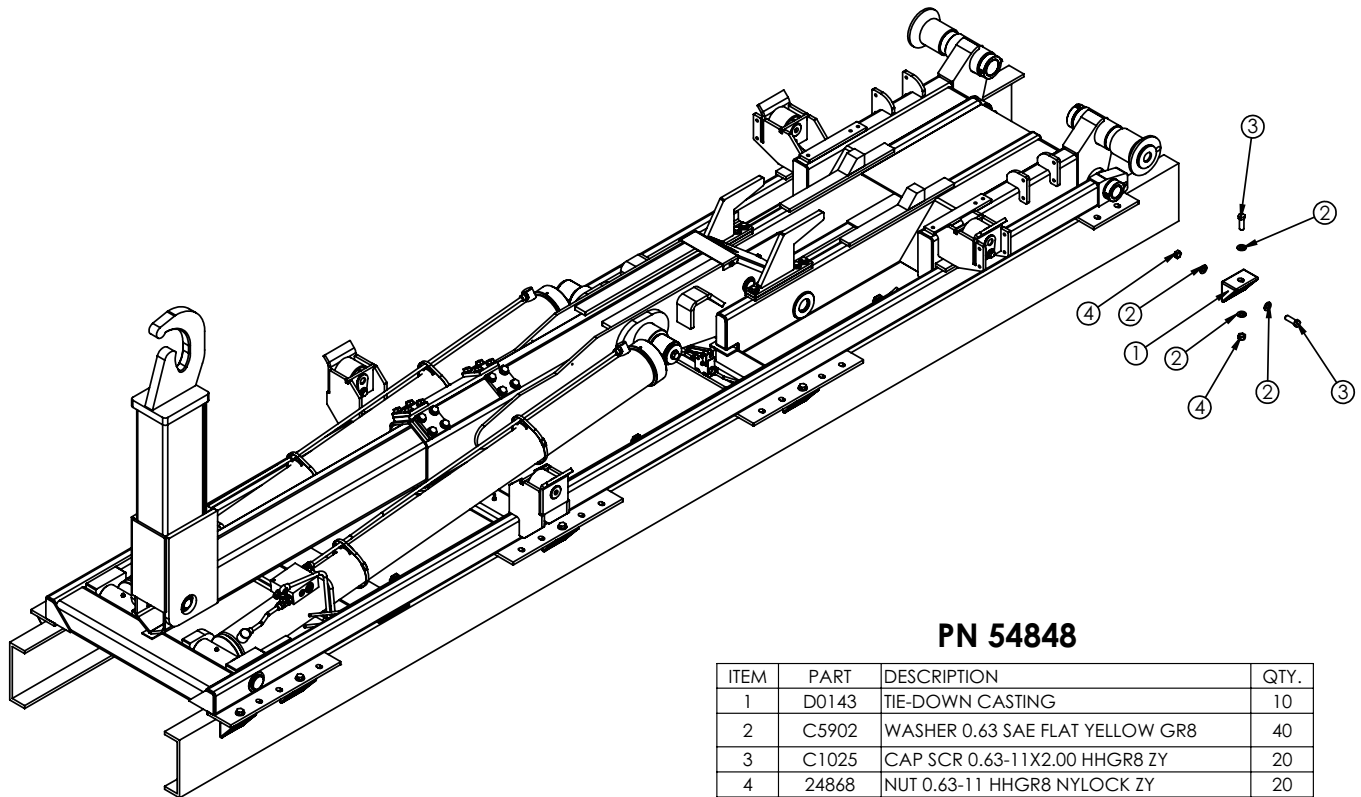

## Step 5: Install taper tower (If applicable).

See brand specific installation instructions.

## Step 6: Install hydraulic reservoir and valve bank.

- Before drilling and bolting to the frame, confirm adequate room for cable routing between in-cab controls and the valve bank. **Note: The top of the reservoir should not be above the truck frame.**

# Reservoir Assembly (2 Section Cable Controls) - PN 70524

## PN 70521

| ITEM | PART  | DESCRIPTION                         | QTY |
|------|-------|-------------------------------------|-----|
| 1    | 26510 | RSRVR ASM 25GAL K MODEL             | 1   |
| 2    | 7353  | FTG 32-32 MP-MP HEX NIPPLE STRAIGHT | 1   |
| 3    | C4694 | ST EL 1.25 90 DEG BLK               | 2   |
| 4    | D0024 | NIPPLE 1.25X1.4.00 BLK              | 1   |
| 5    | C6228 | FILTER HEAD SFT20-25 1.3            | 1   |
| 6    | C6225 | FILTER LARGE SE-10                  | 1   |
| 7    | C4750 | VALVE BALL 2.00                     | 1   |
| 8    | C4730 | FTG 32-32 MP-HB STRAIGHT            | 1   |
| 9    | 24611 | VB 2-SECTION VDM8                   | 1   |
| 10   | 0521  | WASHER 0.25 LOCK                    | 3   |
| 11   | 0339  | CAP SCR 0.25-20X2.50 HHGR5          | 3   |
| 12   | C5968 | FTG 12-12 MFS-MAORB 90              | 1   |
| 13   | C1855 | FTG 6-10 MFS-MORB STRAIGHT          | 2   |
| 14   | C2252 | FTG 8-10 MFS-MORB STRAIGHT          | 2   |
| 15   | 27119 | HOSE 0.75(78C-12-JC-12-12-12-120)   | 1   |
| 16   | 10094 | GAUGE OIL LF 2.5" 0-5000 BM         | 1   |
| 17   | C2375 | FTG 20-12 MP-FP REDUCER BUSHING     | 1   |
| 18   | C4952 | FTG 12-12 MFS-MP STRAIGHT           | 1   |
| 19   | 16145 | GAUGE PRES FILTER SERVICE C120      | 1   |
| 20   | C4819 | HOSE CLAMP 2.00                     | 2   |
| 21   | 17766 | HOSE SUCT 2.00 10FT                 | 1   |
| 22   | 25630 | FTG 10-4 MORB-FP STRAIGHT           | 1   |
| 23   | d1435 | FTG 12-10 MFS-MORB STRAIGHT         | 1   |
| 24   | c4903 | FTG 12-12 MFS-FESS 90               | 1   |
| 25   | 83960 | HOSE 0.75(4500P5J)12FESS SHORT-14CU | 1   |
| 26   | 83959 | MINT KIT RSRVR 25G                  | 1   |

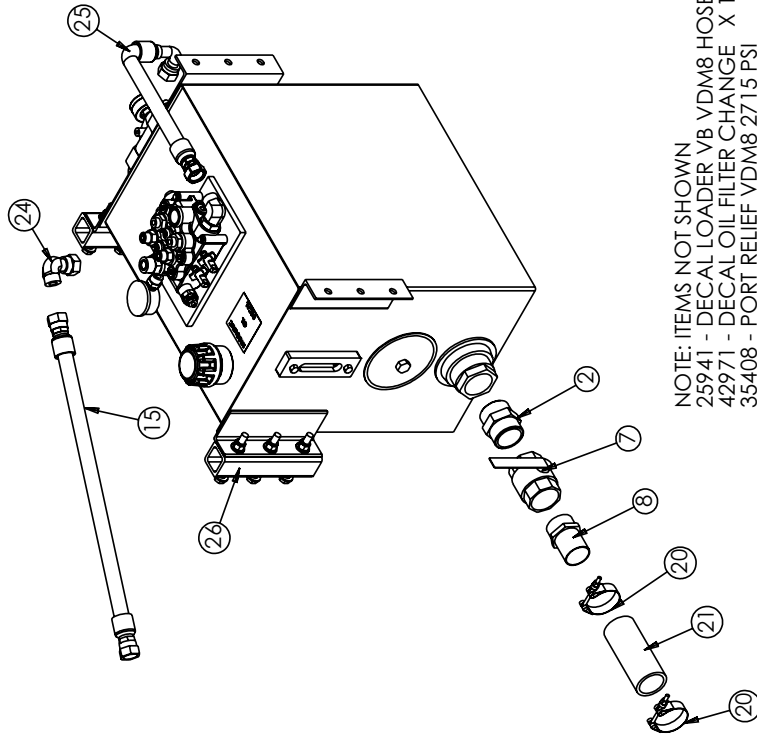

NOTE: ITEMS NOT SHOWN  
 25941 - DECAL LOADER VB VDM8 HOSE LOCATION X 1  
 42971 - DECAL OIL FILTER CHANGE X 1  
 35408 - PORT RELIEF VDM8 2715 PSI

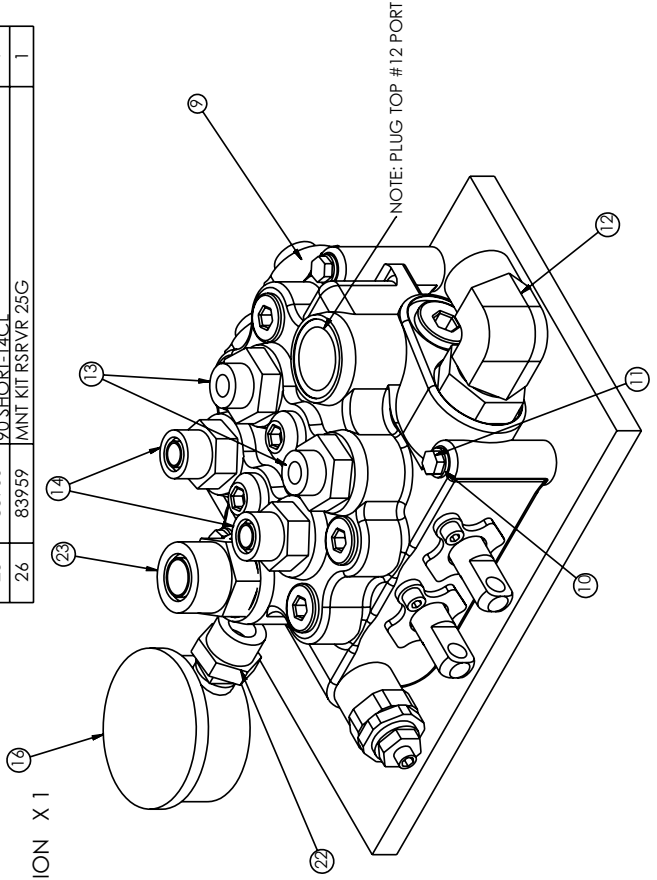

# Reservoir Assembly (3 Section Cable Controls) - PN 70523

## PN 70523

| ITEM | PART  | DESCRIPTION  | QTY. |
|------|-------|--|------|
| 1    | 26510 | RSRVR ASM 25GAL K MODEL                            | 1    |
| 2    | 7353  | FIG 32-32 MP-MP HEX NIPPLE STRAIGHT                | 1    |
| 3    | C4694 | ST EL 1.25 90 DEG BLK                              | 2    |
| 4    | D0024 | NIPPLE 1.25X1.00 BLK                               | 1    |
| 5    | C6228 | FILTER HEAD SF120-25 1.3                           | 1    |
| 6    | C6225 | FILTER LARGE SE-10                                 | 1    |
| 7    | C4750 | VALVE BALL 2.00                                    | 1    |
| 8    | C4730 | FIG 32-32 MP-HB STRAIGHT                           | 1    |
| 9    | 38230 | VB 3-SECT VDM8                                     | 1    |
| 10   | 0521  | WASHER 0.25 LOCK                                   | 3    |
| 11   | C5968 | FIG 12-12 MFS-MAORB 90                             | 1    |
| 12   | 27119 | HOSE 0.75(78C-12-JC-JC-12-12-12-120)               | 1    |
| 13   | 10094 | GAUGE OIL LF 2.5" 0-5000 BM                        | 1    |
| 14   | C2375 | FIG 20-12 MP-FP REDUCER BUSHING                    | 1    |
| 15   | C4952 | FIG 12-12 MFS-MP STRAIGHT                          | 1    |
| 16   | 16145 | GAUGE PRES FILTER SERVICE C120                     | 1    |
| 17   | C4819 | HOSE CLAMP 2.00                                    | 2    |
| 18   | 17766 | HOSE SUCT 2.00 10FT                                | 1    |
| 19   | 25630 | FIG 10-4 MORB-FP STRAIGHT                          | 1    |
| 20   | d1435 | FIG 12-10 MFS-MORB STRAIGHT                        | 1    |
| 21   | c4903 | FIG 12-12 MFS-FESS 90                              | 1    |
| 22   | 0339  | CAP SCR 0.25-20X2.50 HHGR5                         | 3    |
| 23   | C1855 | FIG 6-10 MFS-MORB STRAIGHT                         | 4    |
| 24   | C2252 | FIG 8-10 MFS-MORB STRAIGHT                         | 2    |
| 25   | 83960 | HOSE 0.75(4500PSI)-12FSS SHORT-12FSS 90.SHORT-14CL | 1    |
| 26   | 83959 | MNT KIT RSRVR 25G                                  | 1    |

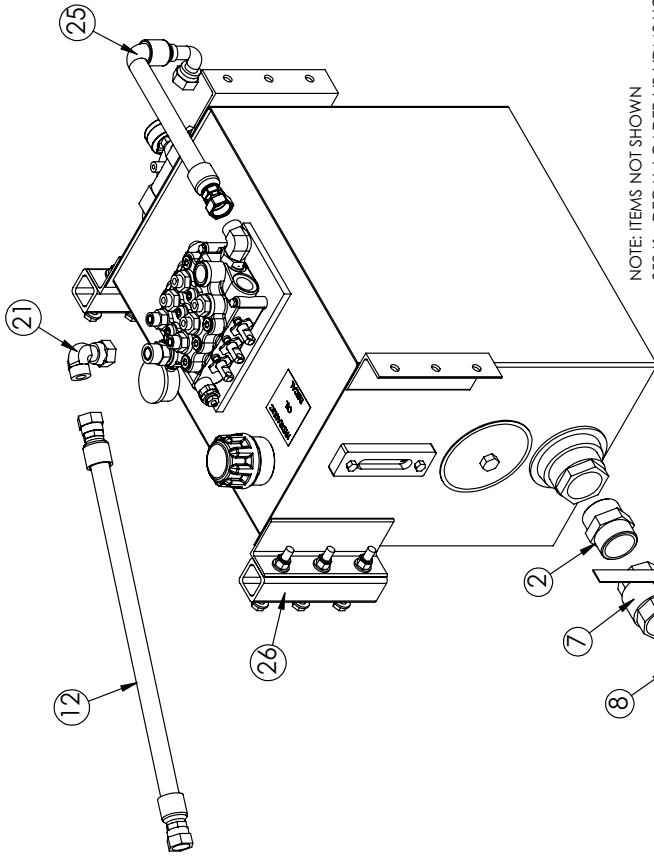

NOTE: ITEMS NOT SHOWN  
 25941 - DECAL LOADER VB VDM8 HOSE LOCATION X 1  
 42971 - DECAL OIL FILTER CHANGE X 1  
 35408 - PORT RELIEF VDM8 2715 PSI X 1  
 26182 - PORT RELIEF VDM8 2500 PSI X 2

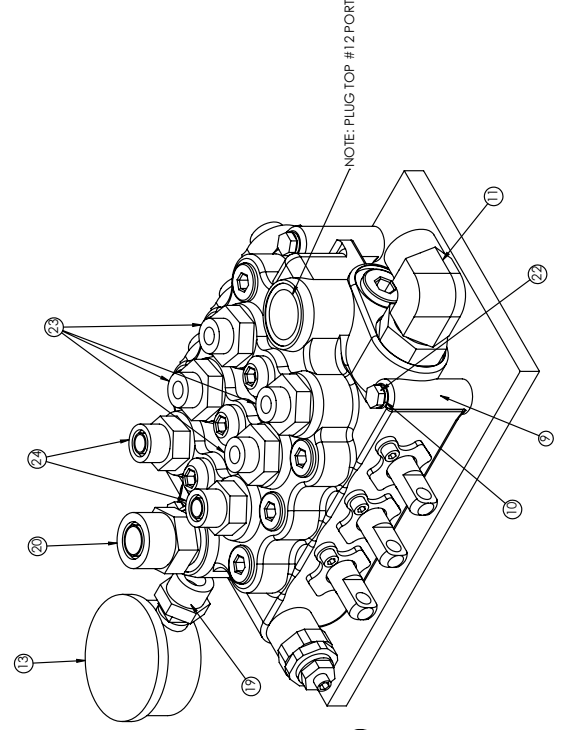
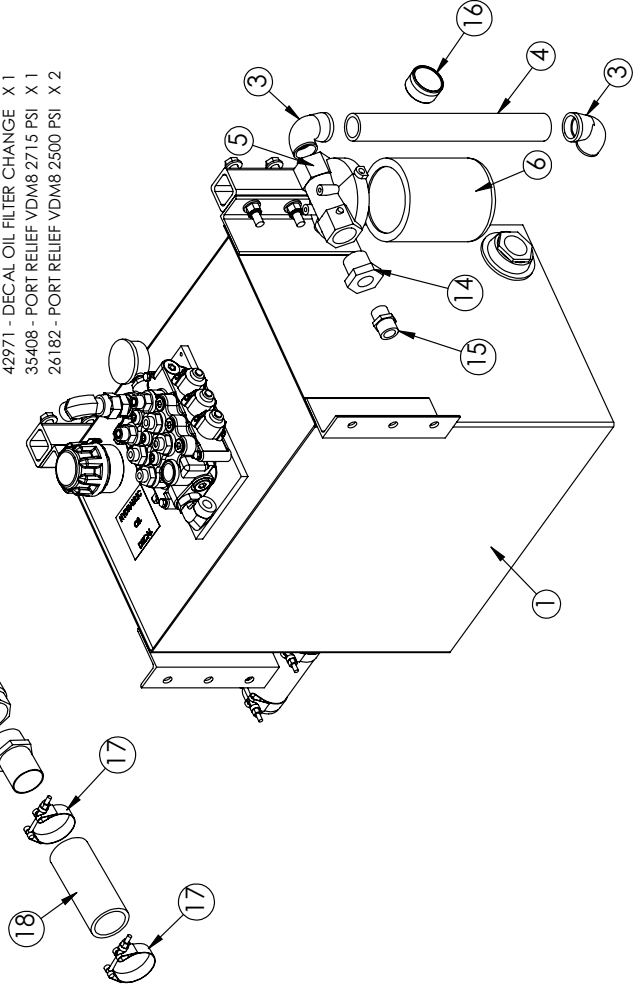

NOTE: PLUG TOP #12 PORT

# Reservoir Assembly (2 Section Air Controls) - PN 70522

## PN 70522

| ITEM | PART  | DESCRIPTION   | QTY. |
|------|-------|---|------|
| 1    | 26510 | RSRVR ASM 25GAL K MODEL                               | 1    |
| 2    | 7353  | FIG 32-32 MP-MP HEX NIPPLE STRAIGHT                   | 1    |
| 3    | C4694 | ST EL 1.25 90 DEG BLK                                 | 2    |
| 4    | D0024 | NIPPLE 1.25X1.4 00 BLK                                | 1    |
| 5    | C6228 | FILTER HEAD SF120-25 1.3                              | 1    |
| 6    | C6225 | FILTER LARGE SE-10                                    | 1    |
| 7    | C4750 | VALVE BALL 2.00                                       | 1    |
| 8    | C4730 | FIG 32-32 MP-HB STRAIGHT                              | 1    |
| 9    | 0521  | WASHER 0.25 LOCK                                      | 3    |
| 10   | C5968 | FIG 12-12 MFS-MAORB 90                                | 1    |
| 11   | 27119 | HOSE 0.75(78C-12-JC-12-12-12-120)                     | 1    |
| 12   | 10094 | GAUGE OIL LF 2.5" 0-5000 BM                           | 1    |
| 13   | C2375 | FIG 20-12 MP-FP REDUCER BUSHING                       | 1    |
| 14   | C4952 | FIG 12-12 MFS-MP STRAIGHT                             | 1    |
| 15   | 16145 | GAUGE PRES FILTER SERVICE CI20                        | 1    |
| 16   | C4819 | HOSE CLAMP 2.00                                       | 2    |
| 17   | 17766 | HOSE SUCT 2.00 10FT                                   | 1    |
| 18   | 25630 | FIG 10-4 MORB-FP STRAIGHT                             | 1    |
| 19   | d1435 | FIG 12-10 MFS-MORB STRAIGHT                           | 1    |
| 20   | c4903 | FIG 12-12 MFS-FFSS 90                                 | 1    |
| 21   | 0339  | CAP SCR 0.25-20X2.50 HHGR5                            | 3    |
| 22   | C1855 | FIG 6-10 MFS-MORB STRAIGHT                            | 2    |
| 23   | 25940 | VB 2-SECTION VDM8 W/AIR ACTUATORS                     | 1    |
| 24   | C2252 | FIG 8-10 MFS-MORB STRAIGHT                            | 2    |
| 25   | 83960 | HOSE 0.75(4500P-SI)-12FFSS SHORT-12FFSS 90 SHORT-14CL | 1    |
| 26   | 83959 | MNT KIT RSRVR 25G                                     | 1    |

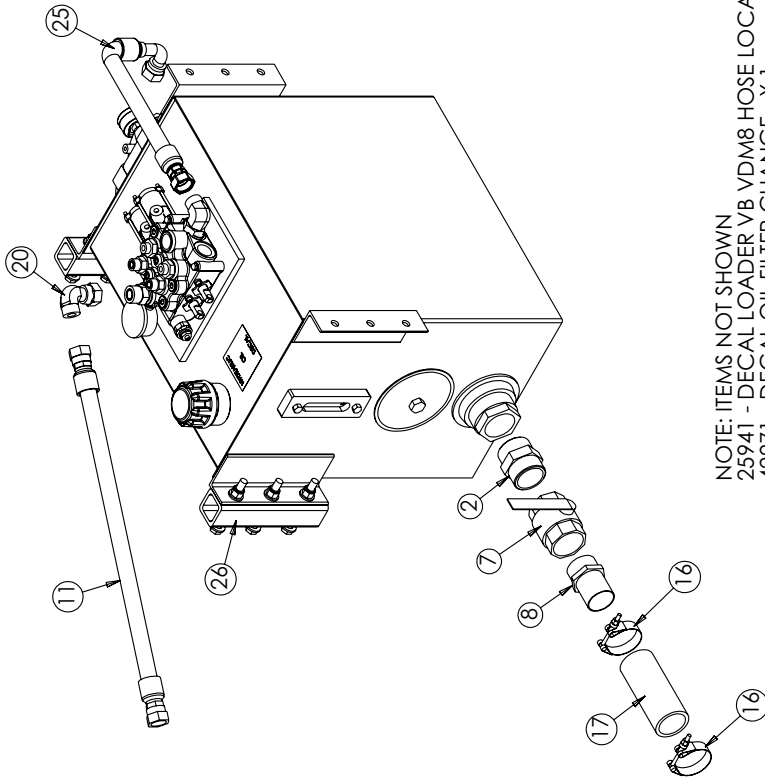

NOTE: ITEMS NOT SHOWN  
 25941 - DECAL LOADER VB VDM8 HOSE LOCATION X 1  
 42971 - DECAL OIL FILTER CHANGE X 1  
 35408 - PORT RELIEF VDM8 2715 PSI

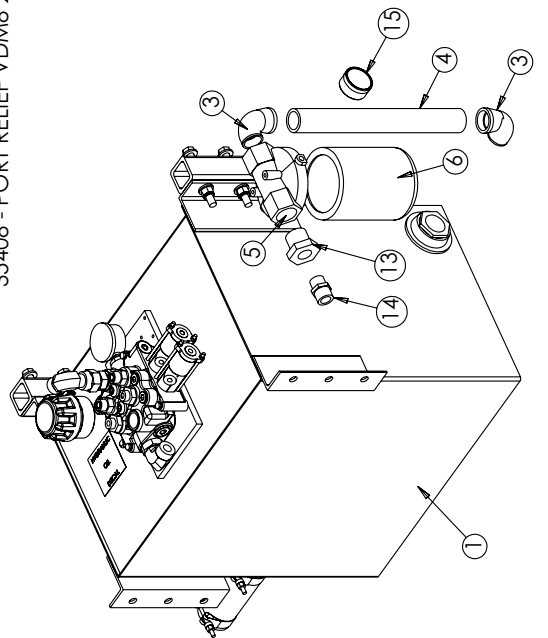
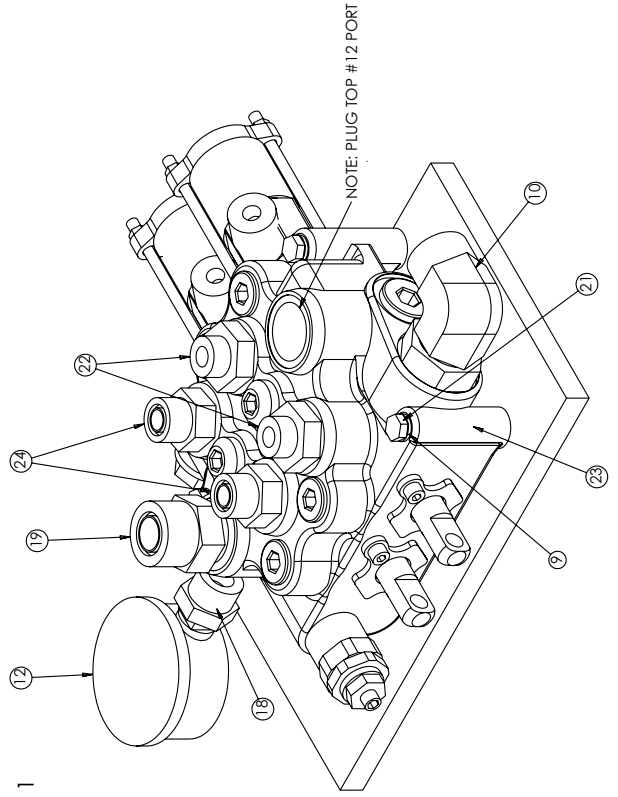

# Reservoir Assembly (3 Section Air Controls) - PN 70524

## PN 70524

| ITEM | PART  | DESCRIPTION  | QTY. |
|------|-------|--|------|
| 1    | 26510 | RSRV ASM 25GAL K MODEL                               | 1    |
| 2    | 7353  | FTG 32-32 MP-MP HEX NIPPLE STRAIGHT                  | 1    |
| 3    | C4694 | ST EL 1.25 90 DEG BLK                                | 2    |
| 4    | D0024 | NIPPLE 1.25X1.400 BLK                                | 1    |
| 5    | C6228 | FILTER HEAD SF120-25 1.3                             | 1    |
| 6    | C6225 | FILTER LARGE SE-10                                   | 1    |
| 7    | C4750 | VALVE BALL 2.00                                      | 1    |
| 8    | C4730 | FTG 32-32 MP-HB STRAIGHT                             | 1    |
| 9    | 47562 | VB 3-SECTION VDM8 W/AIR ACTUATORS                    | 1    |
| 10   | 0521  | WASHER 0.25 LOCK                                     | 3    |
| 11   | C5968 | FTG 12-12 MFS-MAORB 90                               | 1    |
| 12   | C1855 | FTG 6-10 MFS-MORB STRAIGHT                           | 4    |
| 13   | 83960 | HOSE 0.75/4500PSI]-12FFSS SHORT-12FFSS 90.SHORT-14CL | 1    |
| 14   | 27119 | HOSE 0.75/78C-12-JC-12-12-12-120                     | 1    |
| 15   | 10094 | GAUGE OIL LF 2.5" 0-5000 BM                          | 1    |
| 16   | C2375 | FTG 20-12 MP-FP REDUCER BUSHING                      | 1    |
| 17   | C4952 | FTG 12-12 MFS-MP STRAIGHT                            | 1    |
| 18   | 16145 | GAUGE PRES FILTER SERVICE C120                       | 1    |
| 19   | c4819 | HOSE CLAMP 2.00                                      | 2    |
| 20   | 17766 | HOSE SUCT 200 10FT                                   | 1    |
| 21   | 25630 | FTG 10-4 MORB-FP STRAIGHT                            | 1    |
| 22   | d1435 | FTG 12-10 MFS-MORB STRAIGHT                          | 1    |
| 23   | c4903 | FTG 12-12 MFS-FFSS 90                                | 1    |
| 24   | 0339  | CAP SCR 0.25-20X2.50 HHGR5                           | 3    |
| 25   | C2252 | FTG 8-10 MFS-MORB STRAIGHT                           | 2    |
| 26   | 83959 | MNT KIT RSRVR 25G                                    | 1    |

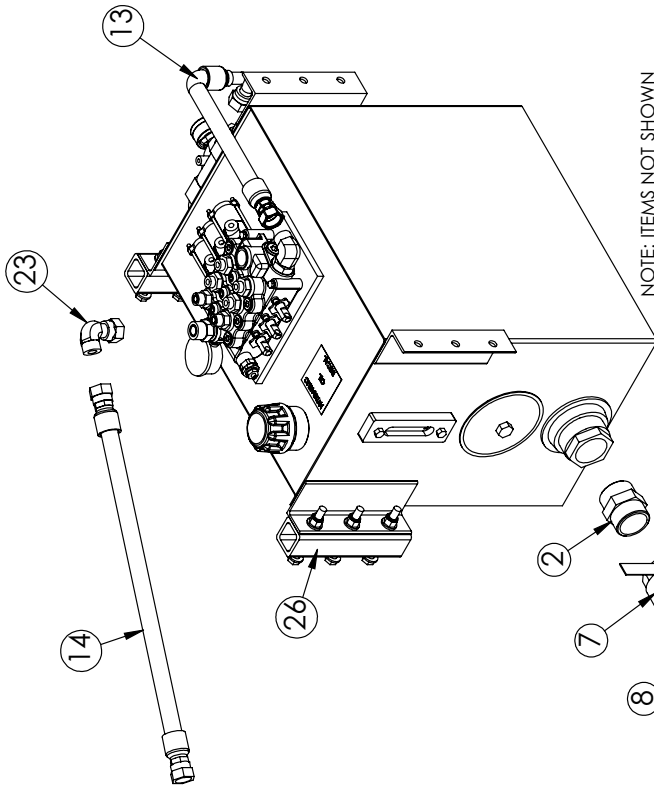

NOTE: ITEMS NOT SHOWN  
 25941 - DECAL LOADER VB VDM8 HOSE LOCATION X 1  
 42971 - DECAL OIL FILTER CHANGE X 1  
 35408 - PORT RELIEF VDM8 2715 PSI X 1  
 26182 - PORT RELIEF VDM8 2500 PSI X 2

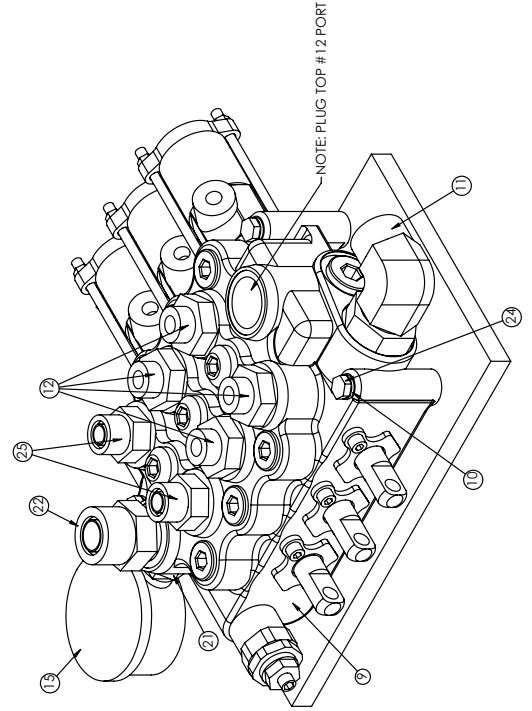
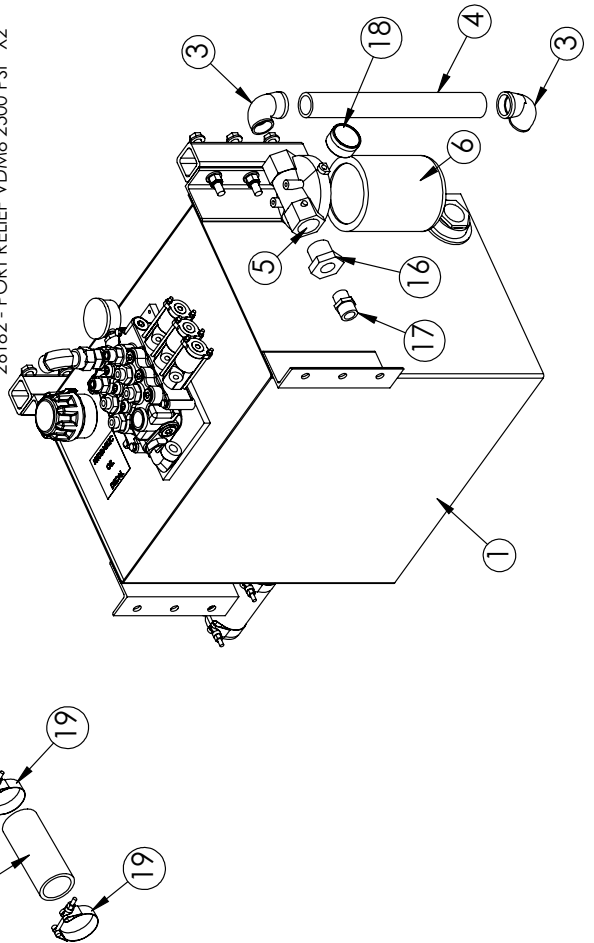



# Valve Bank Parts Drawing

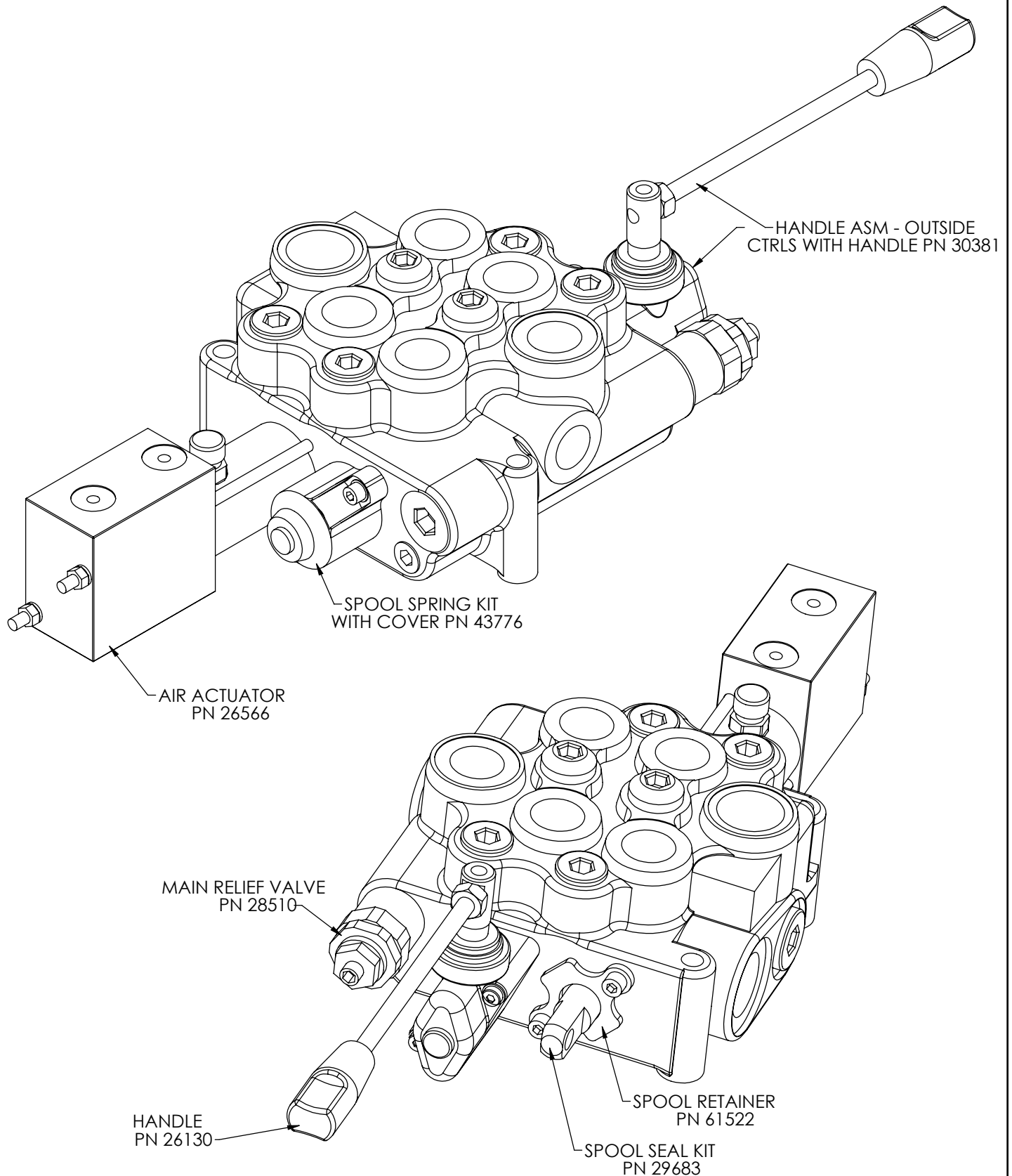

## Step 7: Install PTO and pump.

- Before installing the pump to the PTO, always check the direction of the PTO output shaft to determine which direction the hydraulic pump needs to rotate to operate the equipment. If this is not determined prior to installing the hydraulic pump, the hydraulic pump may rotate in the incorrect direction and damage the front shaft seal.

### PTO Direction of Rotation Tip:

Viewed by standing at the rear of the vehicle, looking forward at the PTO shaft, with the PTO shaft pointing toward the rear of the vehicle:

| P.T.O.  | Driven Equipment  |
|---|---|
| Rotates Opposite Engine<br>(looks "clockwise")    | Driven equipment must rotate counterclockwise (also called left-hand rotation, "A" for anti-clockwise or C.C.W. for counter clockwise). |
| Rotates With Engine<br>(looks "counterclockwise") | Driven equipment must rotate clockwise (also called right-hand rotation or "C" for clockwise).  |

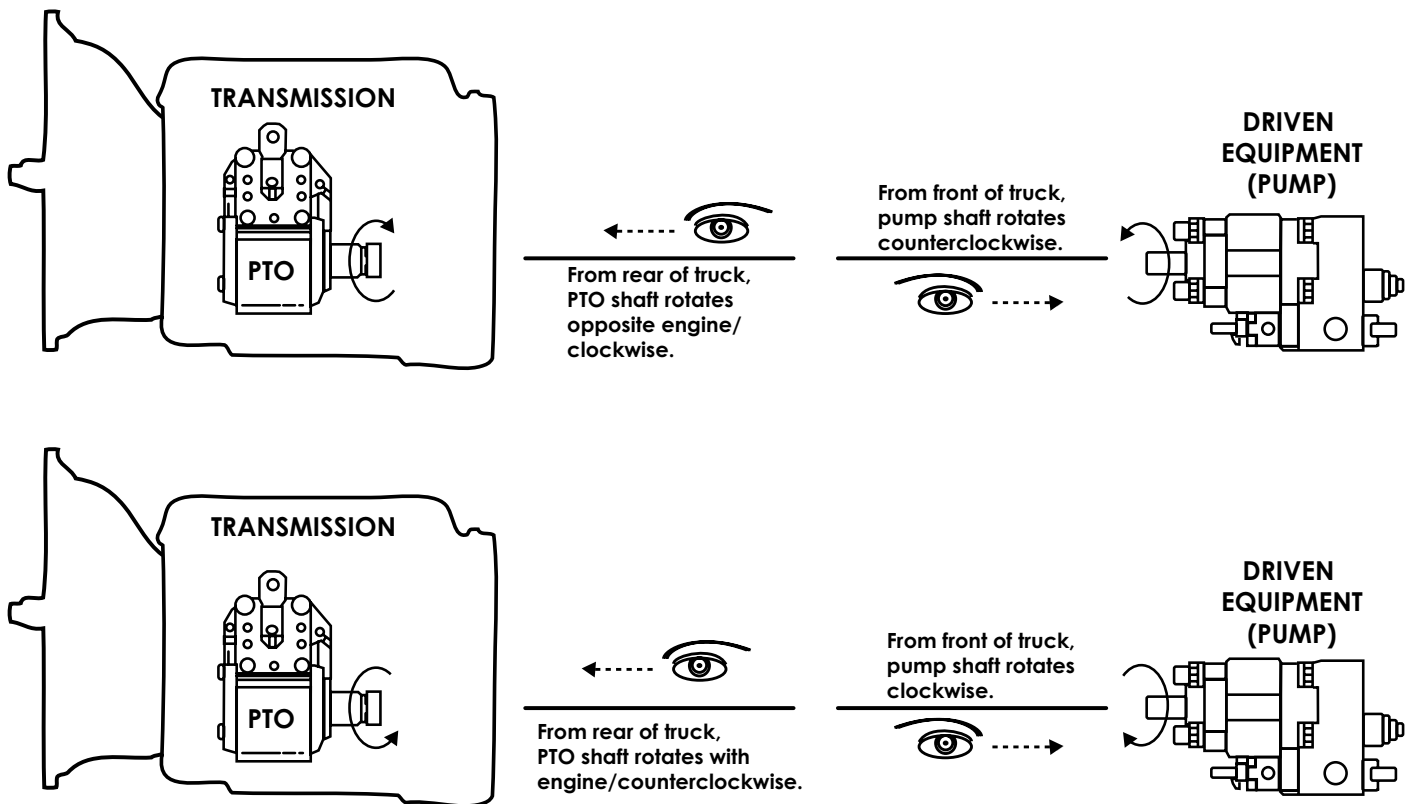

Remember that the PTO is specified by looking from the rear of the truck to the front of the truck. The driven equipment (pump) is specified by looking from the front of the truck to the rear of the truck.

- Use the brand specific PTO/Pump installation instructions. If the directions are not quite clear, contact Stellar® Customer Service or consult with a hydraulic specialty house or company prior to installation.

## Face Seal/O-Ring Size Chart

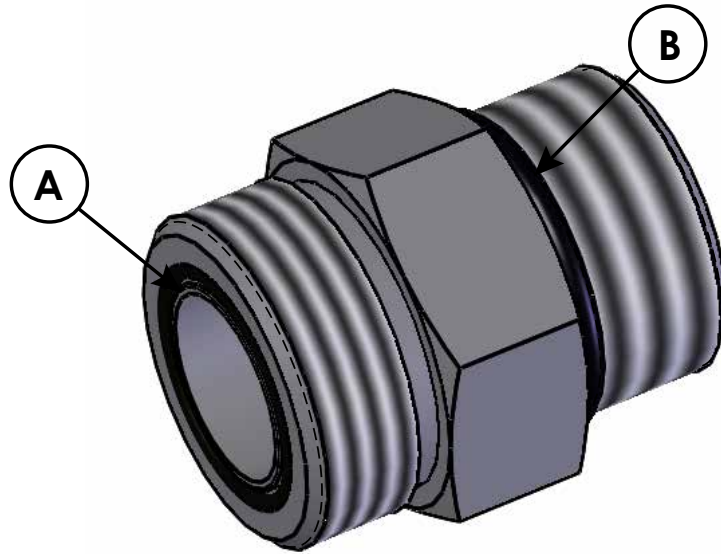

| Hose Size | Fitting Size | Face Seal (A) Stellar® PN | O-ring Boss (B) Stellar® PN |
|-----------|--------------|---------------------------|-----------------------------|
| 1/4"      | #4           | C2027                     | D1245                       |
| 3/8"      | #6           | C2028                     | D1246                       |
| 1/2"      | #8           | C2029                     | D1247                       |
| 5/8"      | #10          | 32223                     | D1248                       |
| 3/4"      | #12          | D1244                     | D1249                       |
| 1"        | #16          |                           | D1250                       |

### Step 8: Route hydraulic hoses.

1. Route hose line from the reservoir to the pump (See hose kit drawing for details).
  2. Route hose line from the pump to the valve bank (See hose kit drawing for details).
  3. Route hose line from the valve bank to the reservoir (See hose kit drawing for details).
  4. Route hose line from the valve bank and the hooklift (See hose kit drawing for details).
- Note: If using the Power Beyond feature for additional function, see "Power Beyond VDM8 Valve" later in this chapter for further details.*

#### Notes on hose line routing:

- Protect these lines with hose wrap when necessary.
- Keep these lines away from sharp edges.
- Keep these lines away from the exhaust or other temperature extreme items.
- Keep these lines away from the driveshaft or other moving items.

# Hose Kit - PN 54851 (Fixed Hook Height Models)

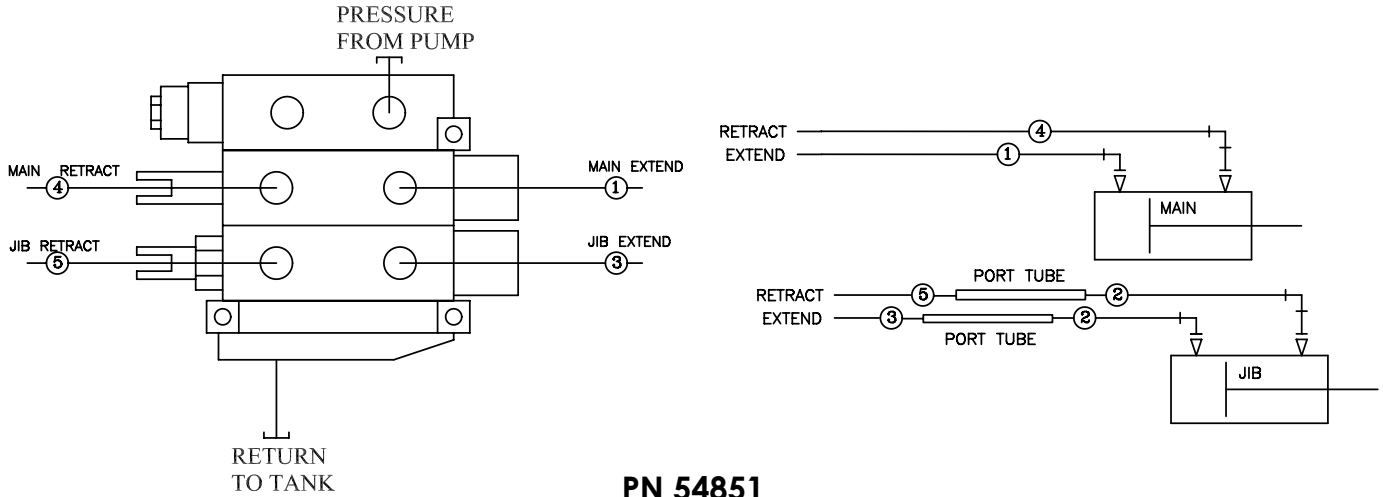

## PN 54851

| 05   | 55361    | HOSE 0.38(471TC-JO-J1-6-6-6-60)  | 1   |
|------|----------|----------------------------------|-----|
| 04   | 55360    | HOSE 0.50(471TC-JC-J1-8-8-8-88)  | 1   |
| 03   | 55352    | HOSE 0.38(471TC-JO-J9-6-6-6-60)  | 1   |
| 02   | 55353    | HOSE 0.38(471TC-JO-J9-6-6-6-110) | 2   |
| 01   | 55354    | HOSE 0.50(471TC-JC-J9-8-8-8-88)  | 1   |
| ITEM | PART No. | DESCRIPTION                      | QTY |

|   |   |  |
|---|---|--|
| <p>STELLAR #55354- (471TC-JC-J9-8-8-8-88")<br/>QTY - 1</p> <p>FUNCTION: MAIN CYLINDER TO VALVE BANK EXTEND</p>  | <p>STELLAR #55353- (471TC-JO-J9-6-6-6-110")<br/>QTY - 2</p> <p>FUNCTION: PORT TUBES TO THE JIB CYLINDER</p>     |  |
| <p>STELLAR #55360- (471TC-JC-J1-8-8-8-88")<br/>QTY - 1</p> <p>FUNCTION: MAIN CYLINDER TO VALVE BANK RETRACT</p> | <p>STELLAR #55361- (471TC-JO-J1-6-6-6-60")<br/>QTY - 1</p> <p>FUNCTION: PORT TUBE TO THE VALVE BANK RETRACT</p> | <p>STELLAR #55352- (471TC-JO-J9-6-6-6-60")<br/>QTY - 1</p> <p>FUNCTION: PORT TUBE TO THE VALVE BANK EXTEND</p> |

# Hose Kit - PN 84189 (Adjustable Hook Height Models)

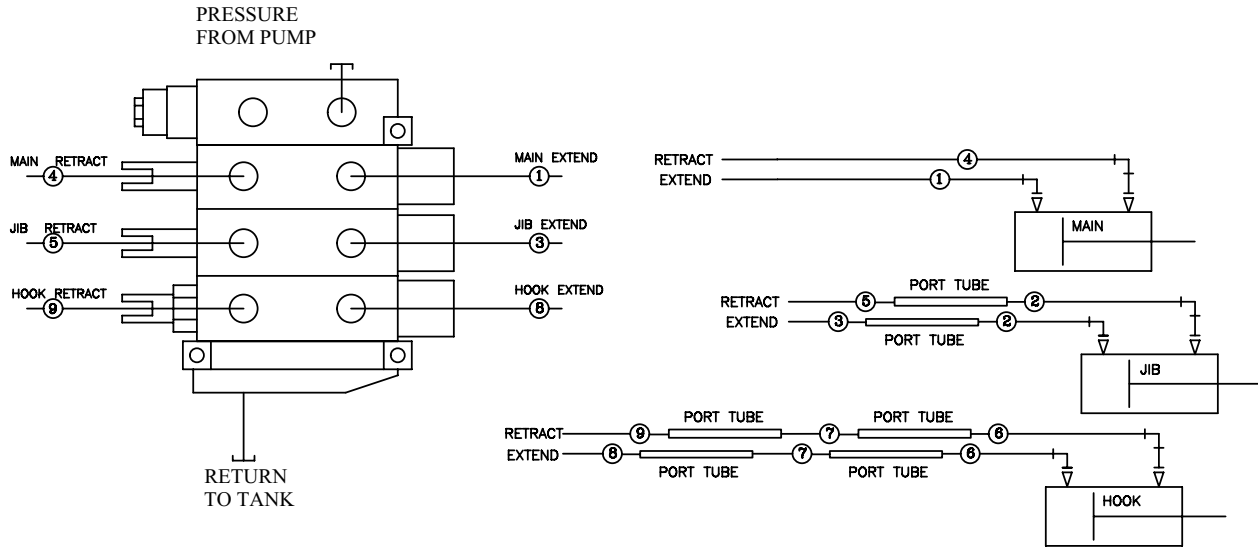

| 09   | 84190    | HOSE 0.25(3000PSI)-4MFS-6FFSS 90 LONG-60CL         | 1   |
|------|----------|--|-----|
| 08   | 84191    | HOSE 0.25(3000PSI)-4MFS-6FFSS 90 SHORT-60CL        | 1   |
| 07   | 84618    | HOSE 0.25(3000PSI)-4MFS-4MFS-110CL                 | 2   |
| 06   | 84617    | HOSE 0.25(3000PSI)-4FFSS SHORT-4MFS-99CL           | 2   |
| 05   | 55361    | HOSE 0.38(4500PSI)-6MFS-6FFSS 90 LONG-60CL         | 1   |
| 04   | 55360    | HOSE 0.50(4500PSI)-8FFSS SHORT-8FFSS 90 LONG-88CL  | 1   |
| 03   | 55352    | HOSE 0.38(4500PSI)-6MFS-6FFSS 90 SHORT-60CL        | 1   |
| 02   | 55353    | HOSE 0.38(4500PSI)-6MFS-6FFSS 90 SHORT-110CL       | 2   |
| 01   | 55354    | HOSE 0.50(4500PSI)-8FFSS SHORT-8FFSS 90 SHORT-88CL | 1   |
| ITEM | PART No. | DESCRIPTION  | QTY |

NOTE: SYSTEM PRESSURE IS 4500 P.S.I.

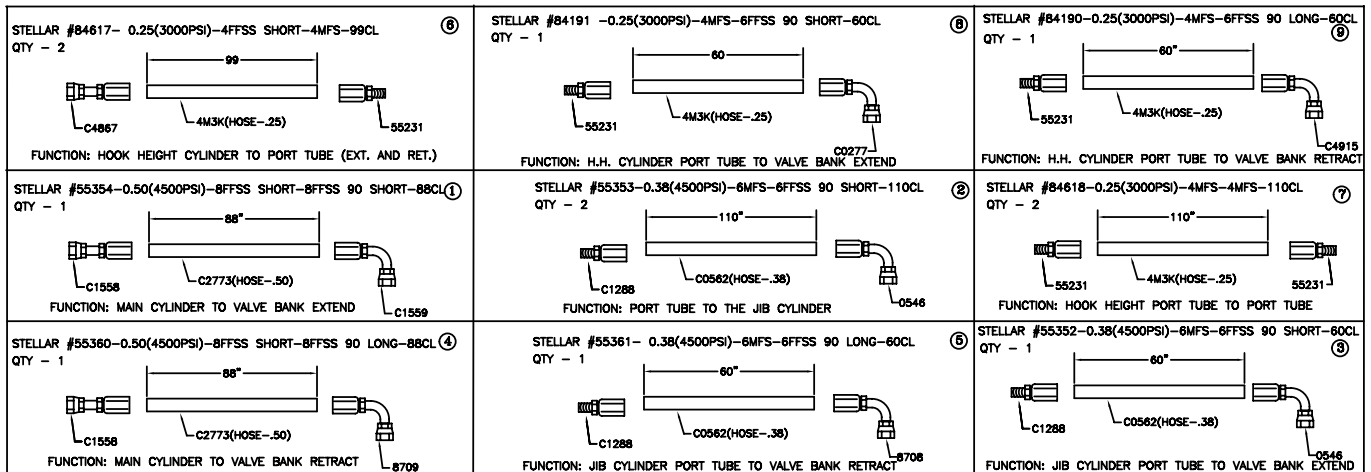

## Power Beyond VDM8 Valve

These instructions are intended for correct installation of power beyond on a Salami VDM8 valve bank. If any hydraulic component is integrated after this valve the power beyond must be installed correctly, or serious damage may incur to the hydraulic system.

1. Remove cover/access plug to reveal the power beyond access point. Can also be used as the Return/Tank port.
2. Install 3/8" straight thread pipe plug (PN 5597) into lower portion of cavity to activate the power beyond feature. Use thread sealer (tape sealers not recommended).

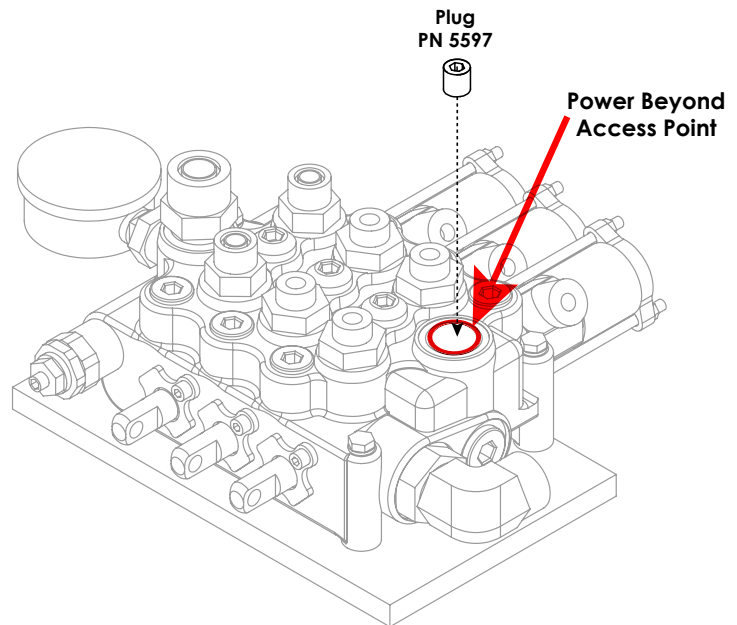

3. The Power Beyond feature is now activated and will divert oil to alternate system via the port shown.

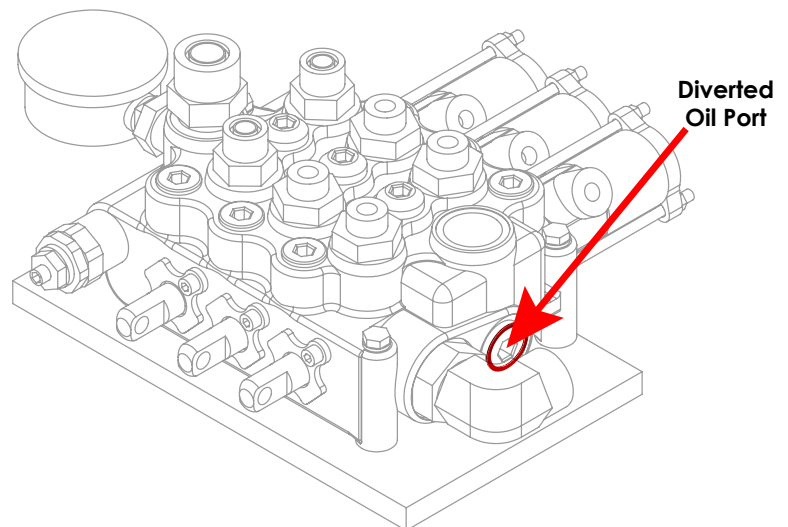

### Notes:

- The return/tank line must be connected to the top or the side port, labeled "T".
- Using the return line to run auxiliary equipment will directly result in a failure and will not in any circumstance be covered under warranty.
- A standard Stellar® Hooklift will have 6 hydraulic lines attached to the valve. With Power Beyond activated, they will have 7 hydraulic lines attached to the valve.

## Port Side Relief Installation

### 2 Section Valve Bank

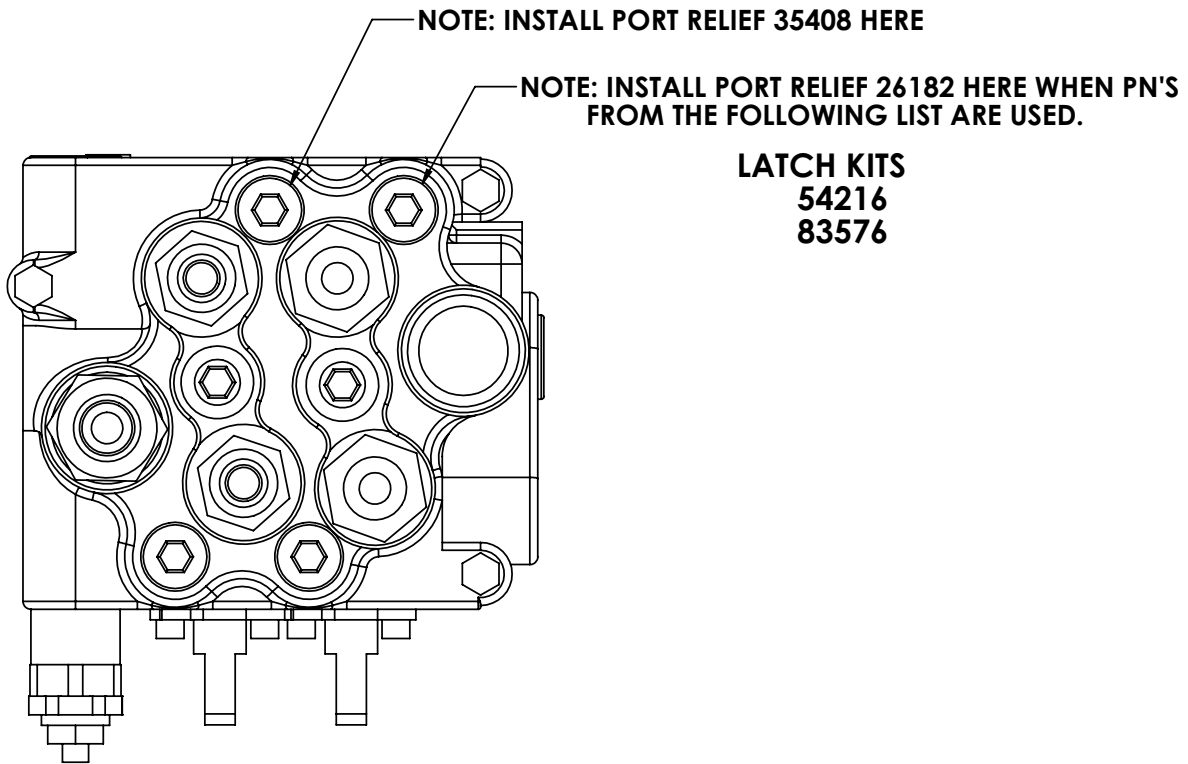

### 3 Section Valve Bank

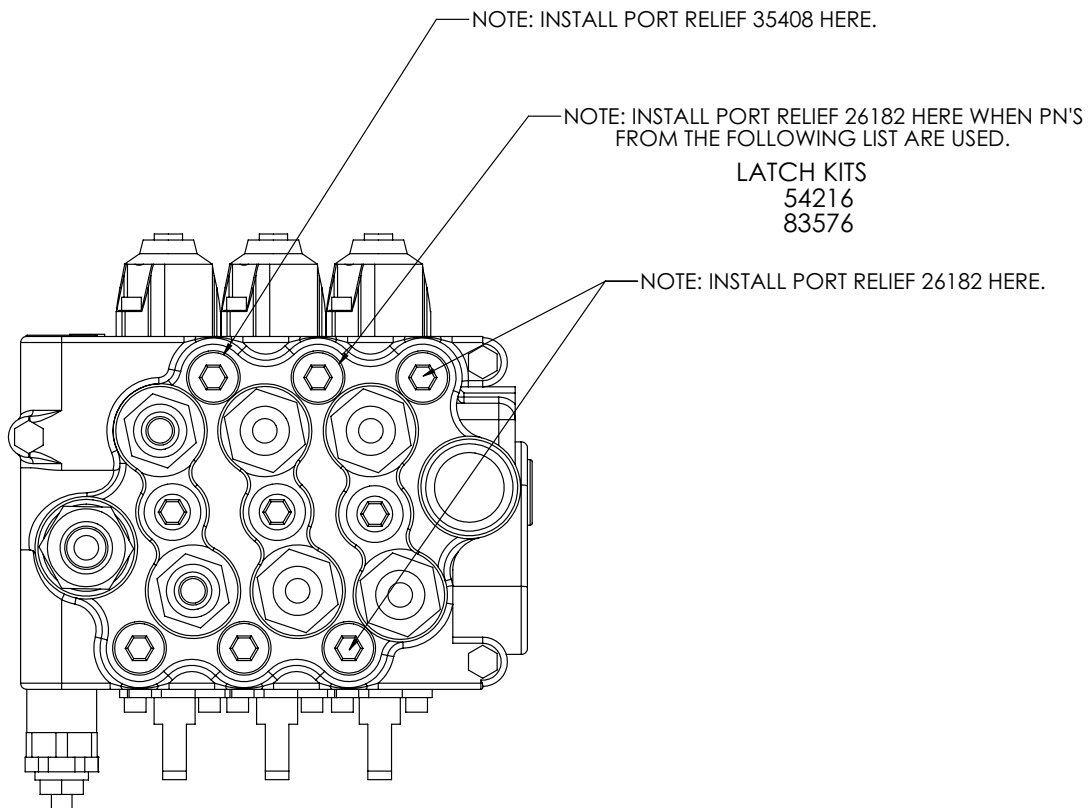

# Step 9: Route Electrical Components

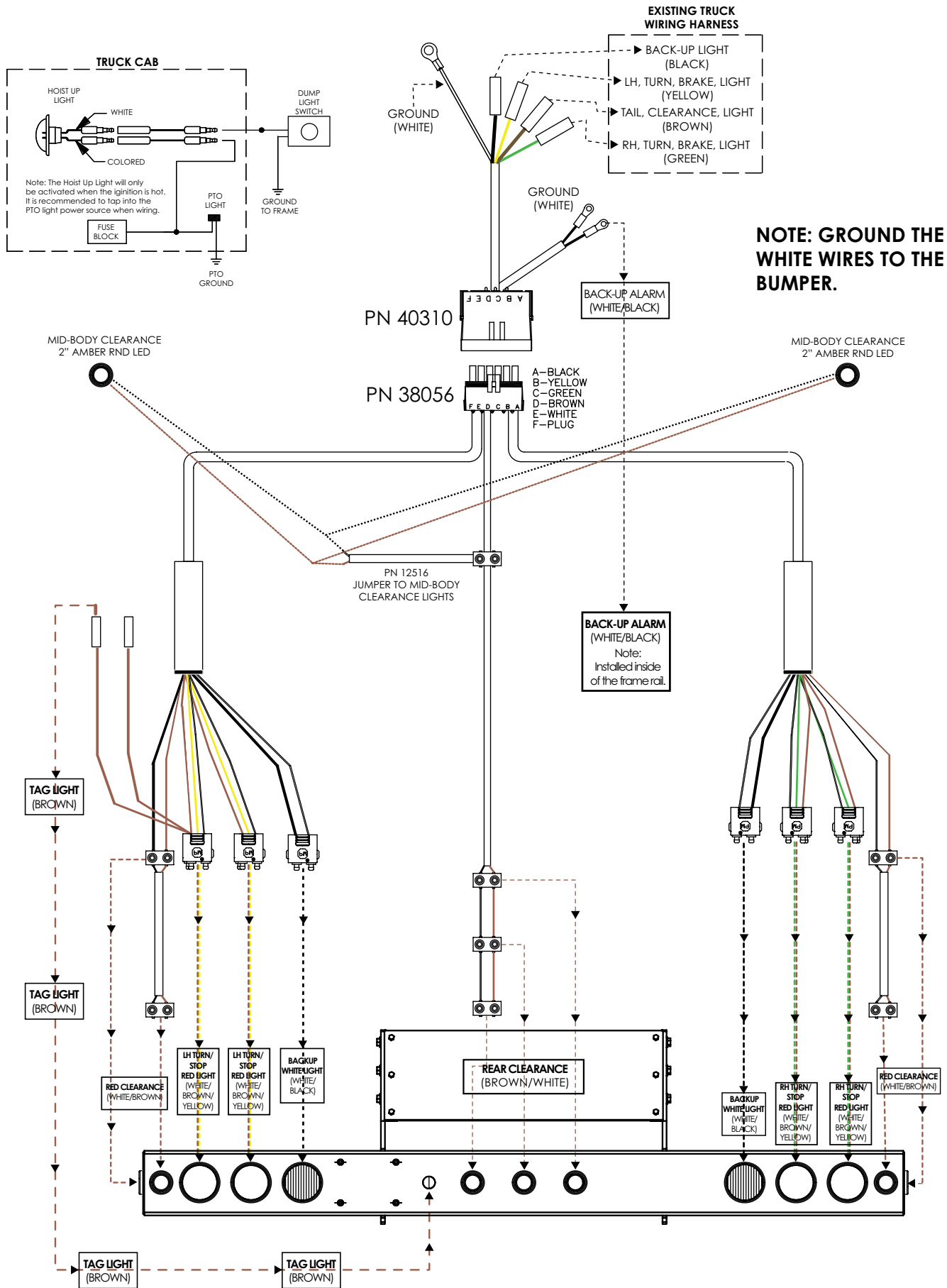

**NOTE: GROUND THE WHITE WIRES TO THE BUMPER.**



# Step 10: Install cab and PTO controls.

- Use PTO brand specific installation instructions.
- For cab controls, see controller assembly drawings for details:

## Cable Controls

### In Cab Installation

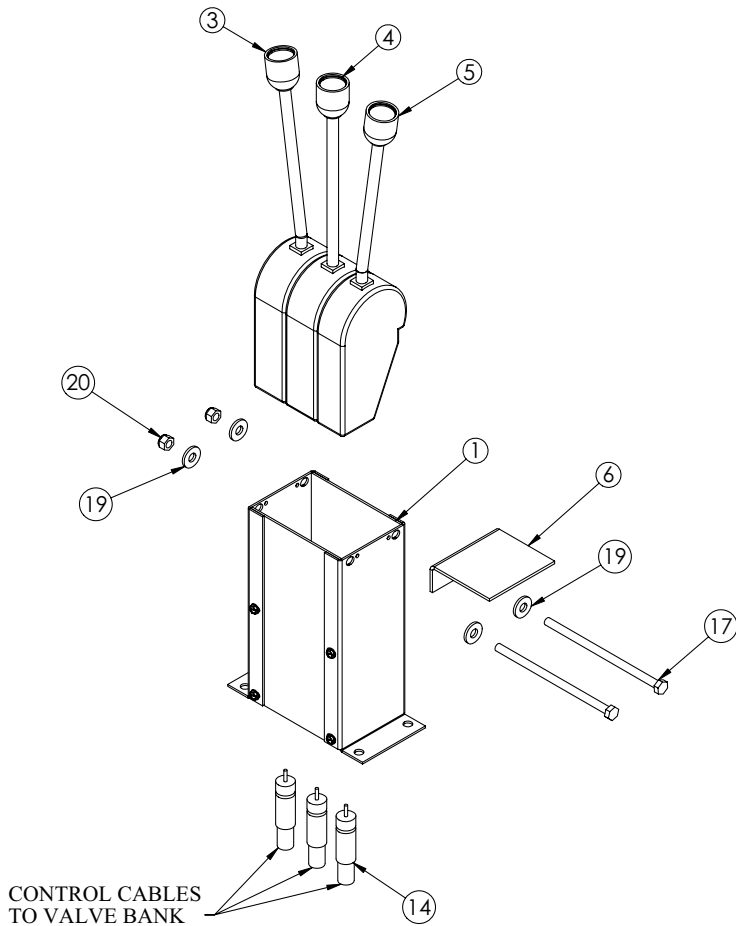

|                 | 2 SECTION | 3 SECTION |
|-----------------|-----------|-----------|
| <b>96 INCH</b>  | PN 55534  | PN 54746  |
| <b>144 INCH</b> | PN 55540  | PN 54747  |
| <b>192 INCH</b> | PN 55541  | PN 54748  |

### At Valve Installation

Valve Bank Shown For Reference

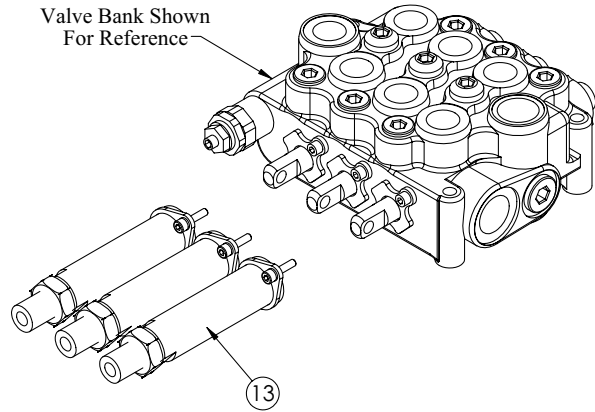

| ITEM | PART  | DESCRIPTION                                    | QTY. |
|------|-------|--|------|
| 1    | 38351 | VALVE CTRL CONSOLE 3LEVER RVC (3 Section Only) | 1    |
| 1    | 37470 | VALVE CTRL CONSOLE 2LEVER RVC (2 Section Only) | 1    |
| 3    | 37475 | CONTROLLER CTR LOCK LEFT BEND                  | 1    |
| 4    | 37476 | CONTROLLER CTR LOCK NO BEND (3 Section Only)   | 1    |
| 5    | 37474 | CONTROLLER CTR LOCK RIGHT BEND                 | 1    |
| 6    | 25933 | BRKT CONTROLLER DECAL                          | 1    |
| 13   | 37469 | CABLE CONN. KIT FOR VD8A/VDM8                  | 2/3  |
| 14   | 37471 | CONTROL CABLE 96 IN WESCON                     | 2/3  |
| 14   | 37472 | CONTROL CABLE 144 IN WESCON                    | 2/3  |
| 14   | 37473 | CONTROL CABLE 192 IN WESCON                    | 2/3  |
| 17   | 20057 | CAP SCR 0.31-18X6.50 HHGR5 (3 Section Only)    | 2    |
| 17   | 0491  | CAP SCR 0.31-18X4.00 HHGR5 (2 Section Only)    | 2    |
| 19   | 0343  | WASHER 0.31 USS FLAT ZINC                      | 4    |
| 20   | 0342  | NUT 0.31-18 HHGR5 NYLOC                        | 2    |

# Air Controls

| ITEM | PART  | DESCRIPTION                                   | QTY. |
|------|-------|---|------|
| 1    | 75868 | CONTROLLER ASM 3 SECT AIR PED                 | 1    |
| 2    | D1810 | TBE AIR SAEJ844 TYPE A .25 (RM)               | 4    |
| 3    | 45333 | FTG .125NPT MALE / .25 TUBE QR KPAC           | 2    |
| 4    | 45687 | FTG ADAPT PTC-MNPT 90 1/4-1/8 NI-PLATED BRASS | 7    |
| 5    | 35211 | PTO AIR REGULATOR 378414                      | 1    |
| 6    | C5934 | NIPPLE 0.25XCLOSE BLK                         | 1    |
| 7    | C1065 | BUSHING 0.50X0.25 BLK                         | 1    |
| 8    | 25940 | VB 2-SECTION VDM8 W/AIR ACTUATORS             | 1    |

**PTO SWITCH**  
**AIR - 62976 (Standard)**  
**ELECTRIC\* - PN 63142 (Optional)**  
 \* Note: When using PN 63142, an adapter plate (PN 63143) is required.

| HOSE    | FUNCTION    |
|---------|-------------|
| BLACK   | EXHAUST     |
| SILVER  | SUPPLY      |
| BLUE    | SLIDE IN    |
| GREEN   | SLIDE OUT   |
| ORANGE  | LIFT LOAD   |
| WHITE   | LIFT UNLOAD |
| RED     | PTO         |
| YELLOW* | HOOK RAISE  |
| YELLOW* | HOOK LOWER  |

\*When Used with 3rd Section

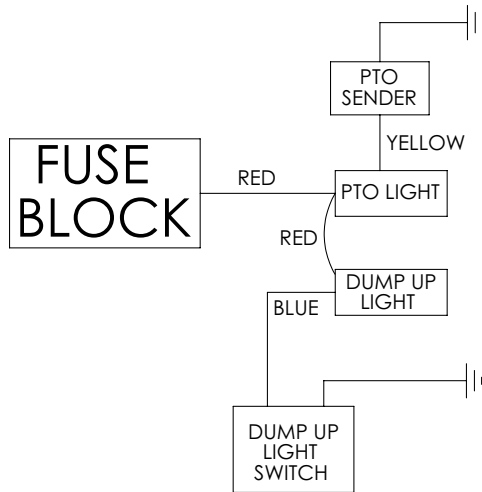
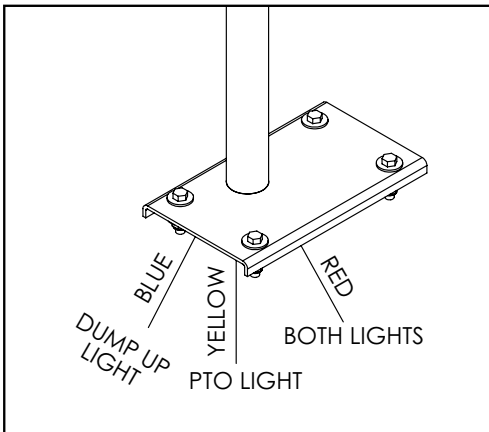
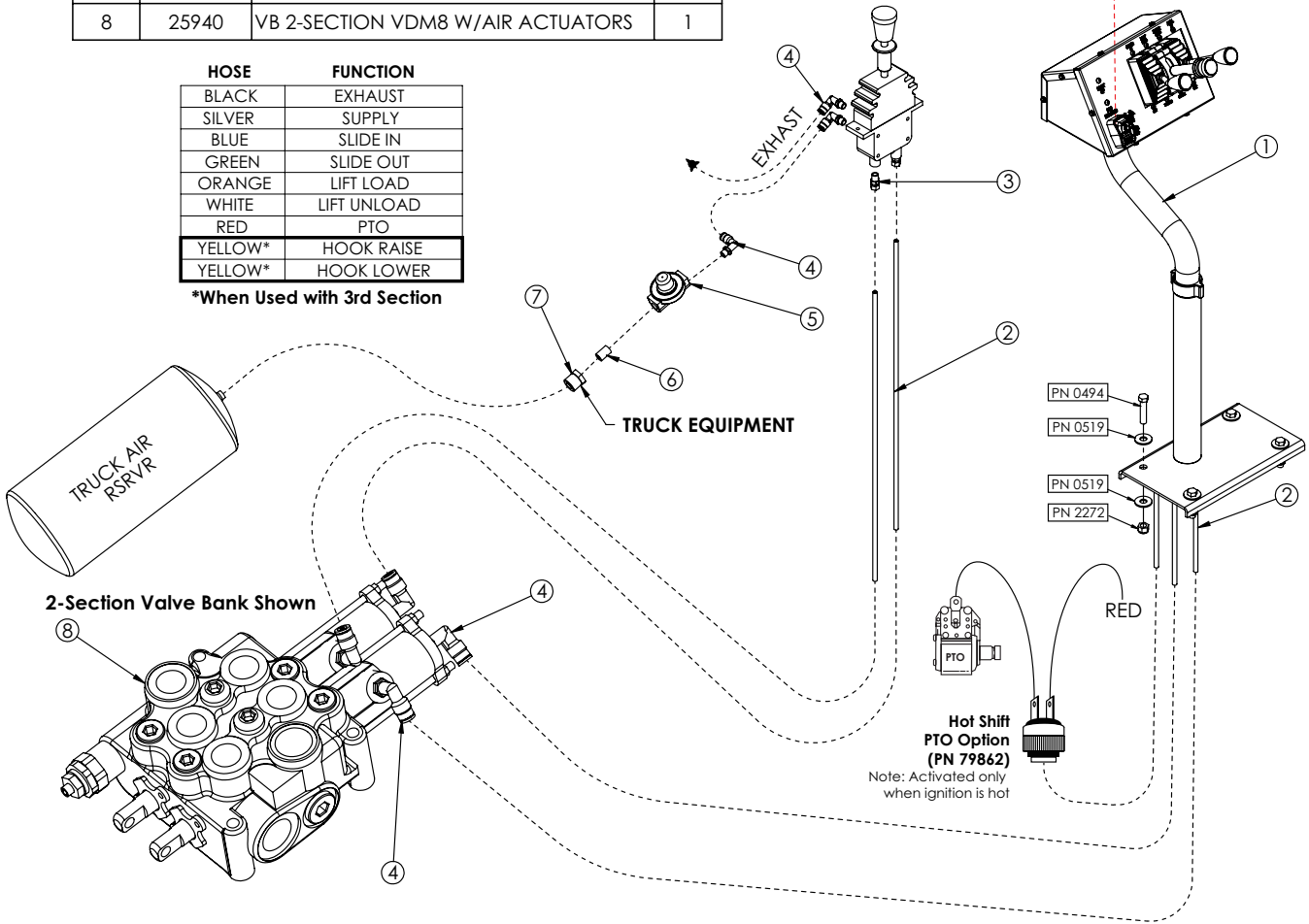

NOTE: THE HOIST UP LIGHT WILL ONLY BE ACTIVATED WHEN THE IGNITION IS HOT. IT IS RECOMMENDED TO TAP INTO THE PTO LIGHT POWERSOURCE WHEN WIRING.

## Optional - Controller Pedestal Reinforcement

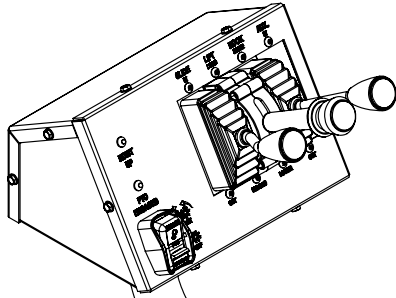

If the chassis floor is too thin to provide sturdy support for the controller pedestal, use the optional support hardware:

| ITEM | PART    | DESCRIPTION                | QTY. |
|------|---------|----------------------------|------|
| 5    | 0335    | CAP SCR 0.38-16X1.25 HHGR5 | 2    |
| 6    | 0347    | NUT 0.38-16 HHGR5 NYLOC    | 2    |
| 7    | CLAMP   | CLAMP 2.00 BLK VINYL       | 1    |
| 8    | BRACKET | BRKT 10GAX2.00X24.00       | 1    |

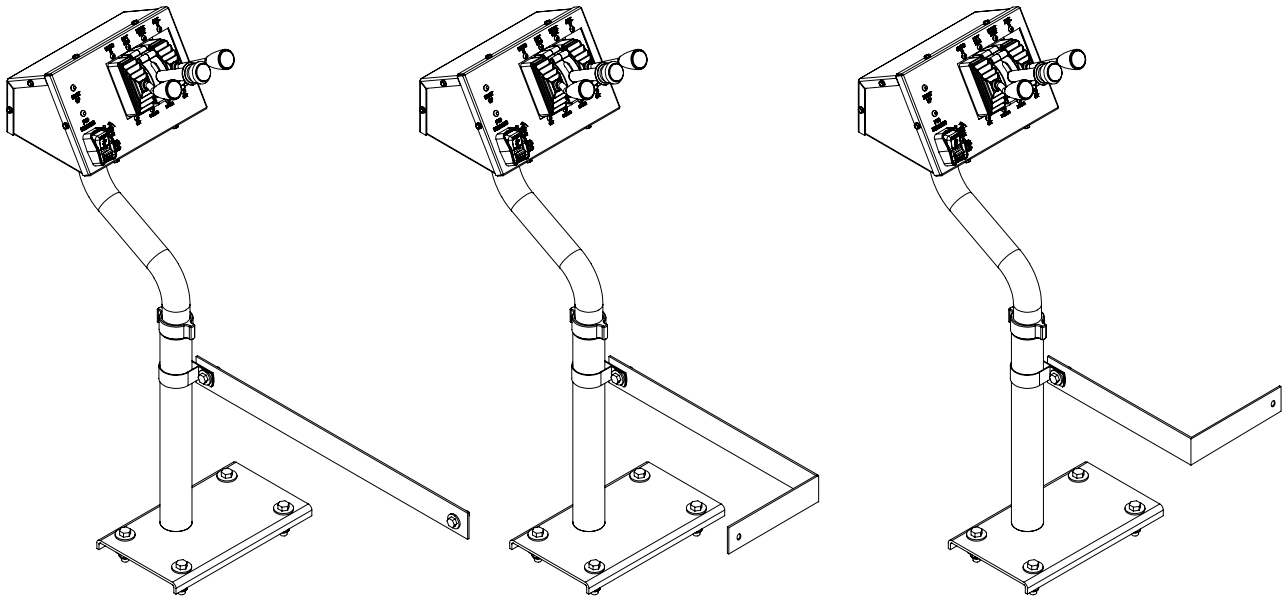
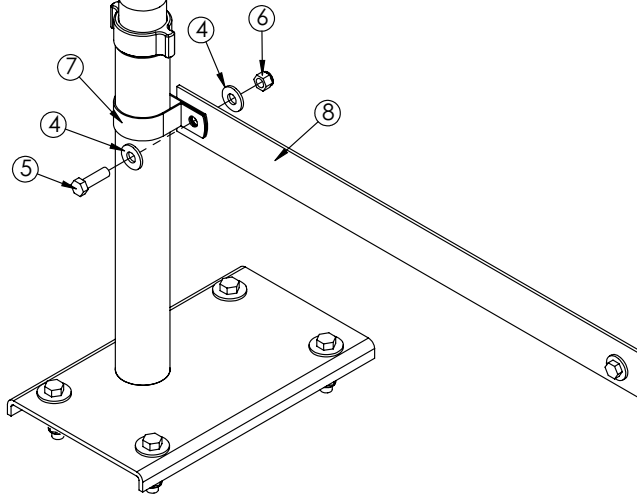

**Note:** The bracket can be bent, cut, trimmed, etc to allow fastening to the structure under the passenger seat.

# Step 11: Install mud flaps and fenders.

See brand specific installation instructions.

# Step 12: Install Hoist Up Light Sensor - PN 83115

Install the hoist up light sensor onto the base of the hooklift as shown:

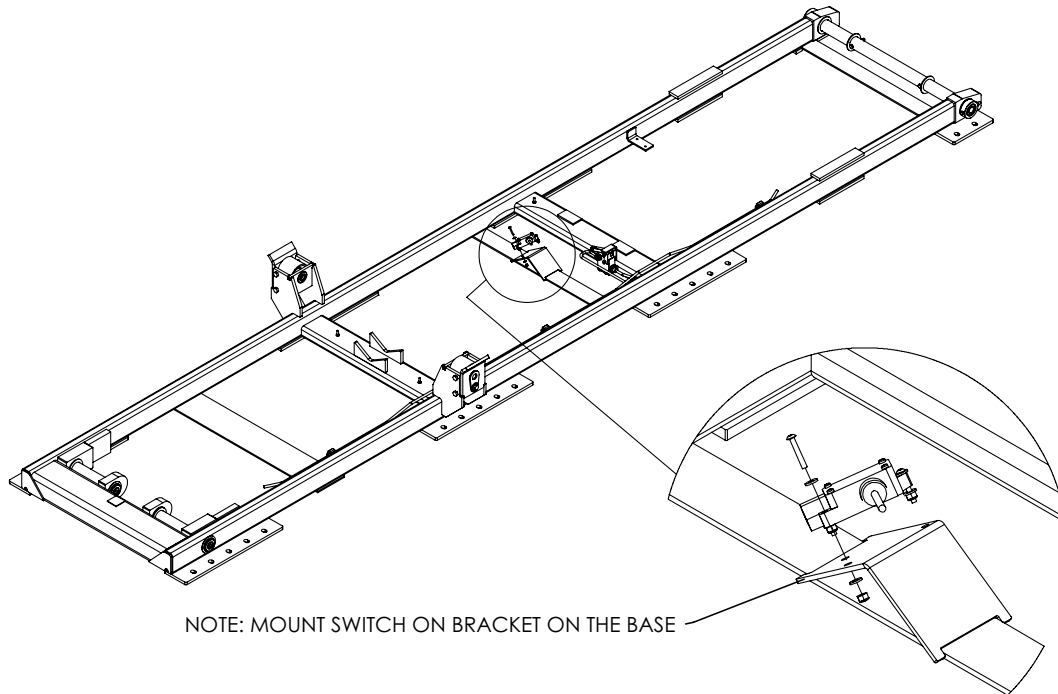

NOTE: MOUNT SWITCH ON BRACKET ON THE BASE

| ITEM | PART  | DESCRIPTION                  | QTY. |
|------|-------|------------------------------|------|
| 1    | 45907 | SWITCH REMOTE KP60           | 1    |
| 2    | 30472 | CAP SCR #10-24X1.25 BTNHD SS | 3    |
| 3    | D0178 | WASHER #10 SAE FLAT          | 6    |
| 4    | 26034 | NUT #10-24 HH NYLOC          | 3    |

ITEMS NOT SHOWN:  
 C0073 - TERML 16-14 BLUE BUTT WATER TIGHT X 1  
 29409 - TERML 12-10X.31 RING X 1

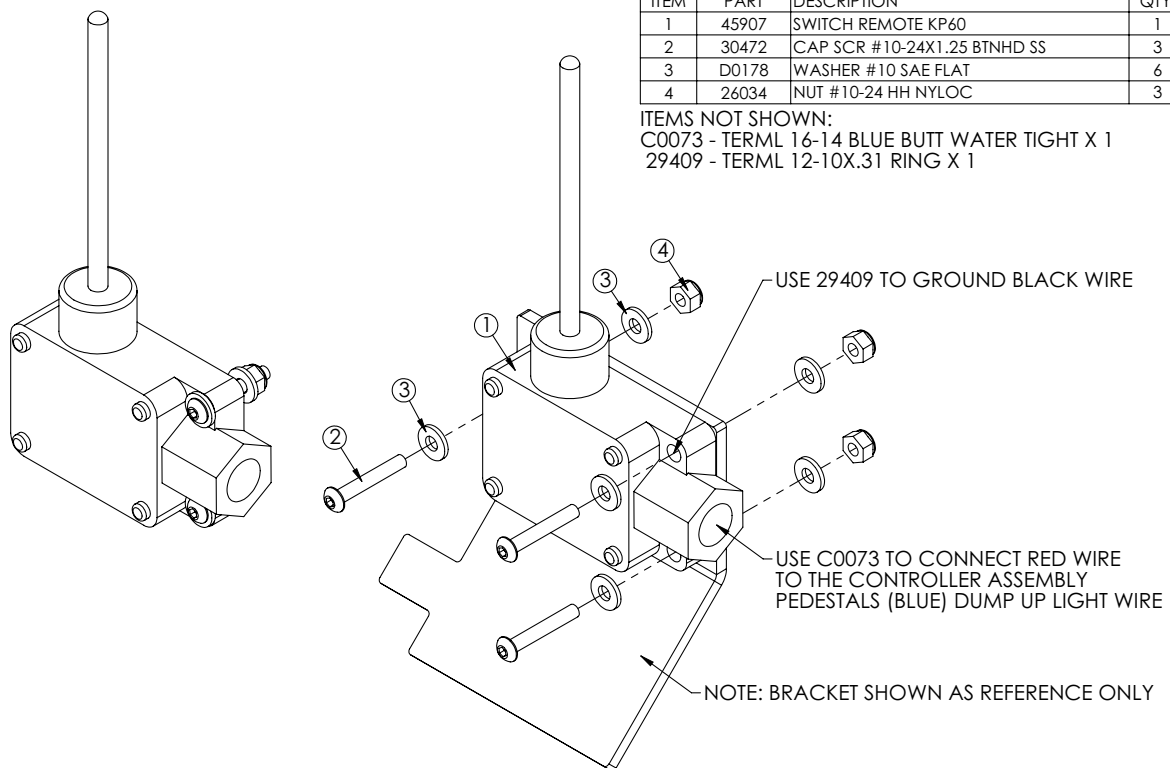

# Step 13: Apply Decals

## DECAL PLACEMENT FOR STELLAR® SLIDER HOOKLIFTS

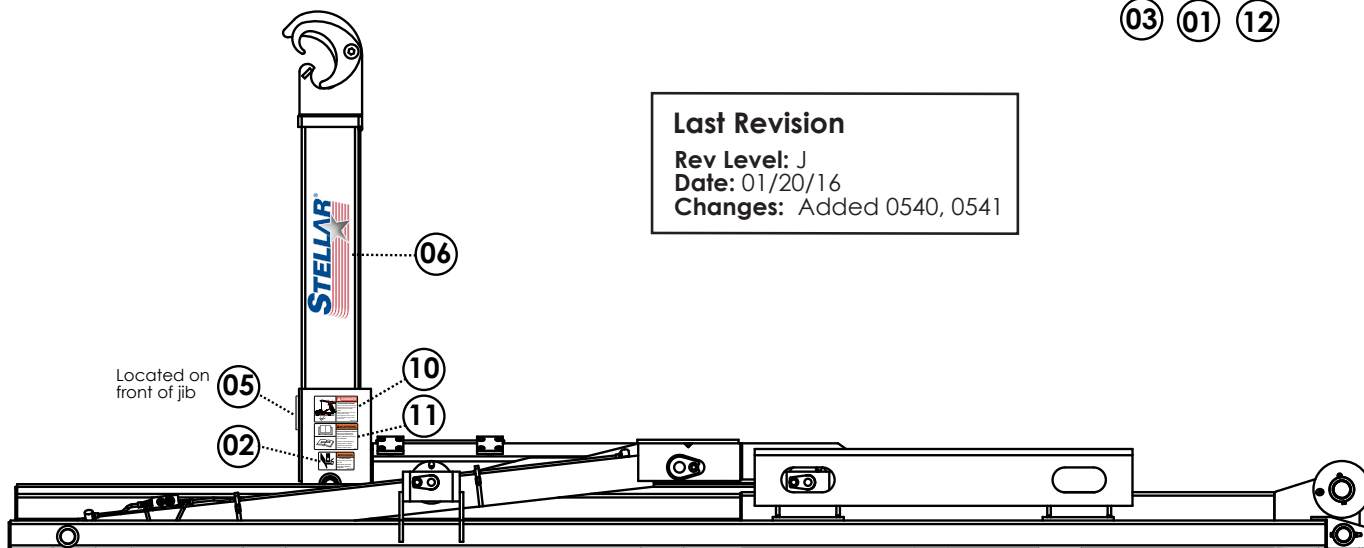
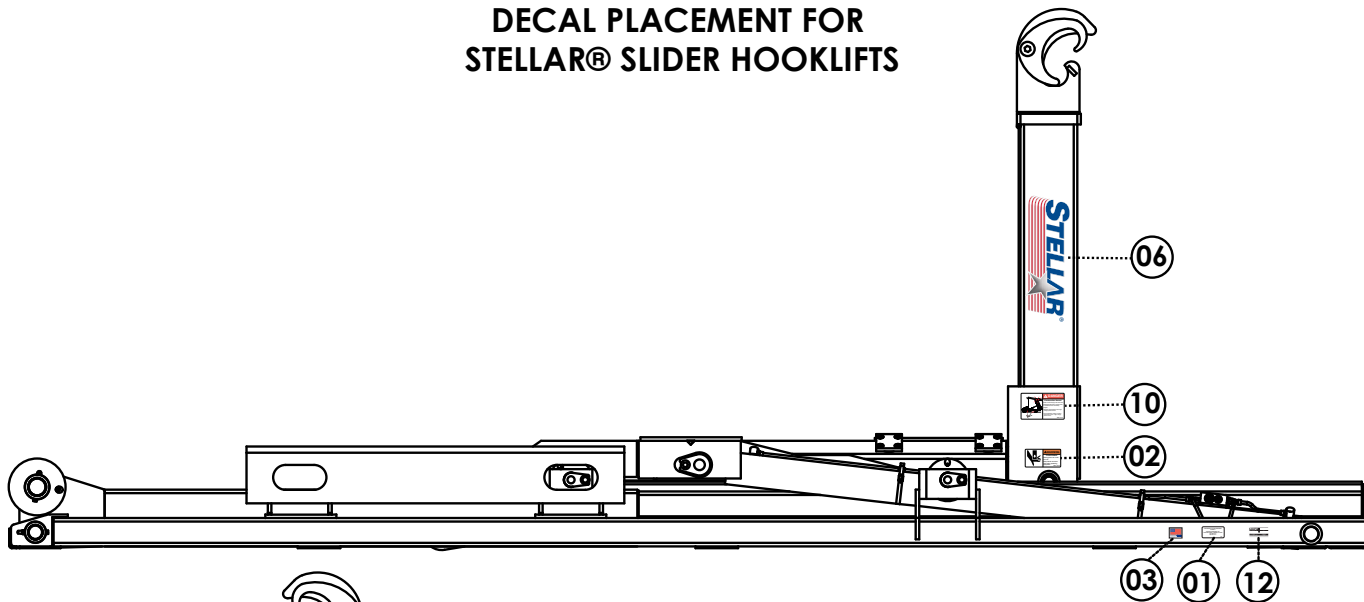

### PN 31827

| ITEM  | PART NUM | DESCRIPTION                               | QTY |
|-------|----------|---|-----|
| 01    | 4214     | DECAL CONTACT STELLAR                     | 1   |
| 02    | 25627    | DECAL WARNING CRUSH                       | 2   |
| 03    | 35234    | DECAL STELLAR MADE IN THE USA             | 1   |
| 04    | 39211    | DECAL HOOKLIFT LEVER LIFT                 | 2   |
| 05    | 45955    | DECAL WARNING HOOK HEIGHT MATCH           | 1   |
| 06*   | 52681    | DECAL STELLAR LOGO 6.00X16.50             | 3   |
| 07    | 55414    | DECAL HOOKLIFT LEVER HOOK (IF APPLICABLE) | 2   |
| 08    | 55754    | DECAL HOOKLIFT LEVER SLIDE                | 2   |
| 09    | 55755    | DECAL SLIDER CONTROLS                     | 1   |
| 10    | 55832    | DECAL DANGER ELECTROCUTION HOOK           | 2   |
| 11    | 68024    | DECAL WARNING UNTRAINED OPERATOR          | 1   |
| 12**  | C5942    | PLATE STELLAR SERIAL                      | 1   |
| 13*** | 79983    | DECAL DANGER ELECTROCUTION FRONT BUMPER   | 1   |
| 13*** | 0540     | DECAL AMBER REFLECTOR 3.00 ROUND          | 2   |
| 14*** | 0541     | DECAL RED REFLECTOR 3.00 ROUND            | 4   |

- \* Extra QTY 1 shipped loose.
- \*\* This item not included in decal kit.
- \*\*\* This decal not shown.

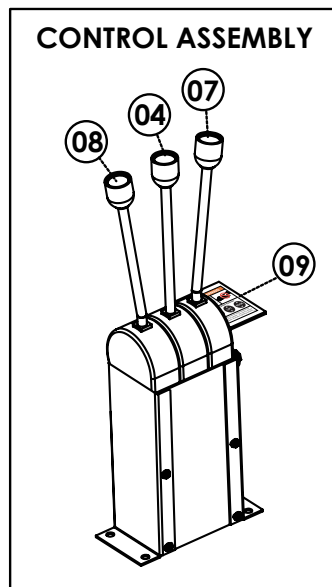

## Step 14: Fill reservoir and activate hydraulic flow.

- Fill reservoir to site gauge, within 3" from the top (Roughly 25 Gallons). Note: ISO 32 hydraulic oil is recommended.
- When connections are secure, activate hydraulic flow by opening the ball valve on the bottom of the reservoir. This will allow oil to flow from the reservoir to the pump.

## Step 15: Operate hooklift.

- **⚠ WARNING** Stellar® Hooklift operators must conform to the qualifications specified in the *Slider Hooklift Safety, Operation, Maintenance, Troubleshooting Manual*. Read and understand all manuals and safety signs before operating or servicing this equipment.
- Bleed the air out of the hydraulic system.
- Check the hydraulic oil level and add oil if needed. When checking hydraulic oil level, make certain that **all system cylinders** are fully retracted.
- Calibrate dump light system.
- Be sure to check all clearances.
- Set/check relief pressure no higher than 4500 PSI (See procedure on next page).

### Set System Relief Pressure

1. Engage the PTO. Run the PTO at 1200 RPM.
2. Push the control lever labeled 'lift' until the boom bottoms out. Keep pushing the lever forward until the pressure is set.

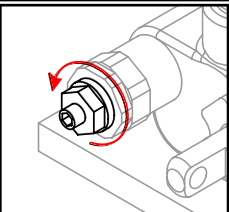

3. Locate the main relief valve and release the jam nut using a 13 mm wrench.

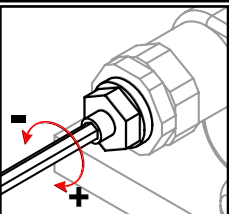

4. Adjust the system relief pressure using 4 mm allen wrench. Clockwise increases pressure, counter clockwise decreases pressure.

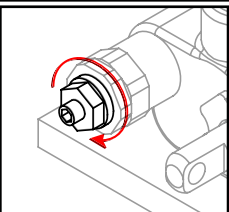

5. Once system pressure is set, tighten the jam nut to lock system pressure. Permanent thread lock should not be used.

6. Release all functions and disengage the PTO. Snap tamper cap into position over the jam nut. The break away clip will be destroyed if the cap is removed.

# Chapter 3 - Assembly Drawings

## Base Assembly - PN 65658

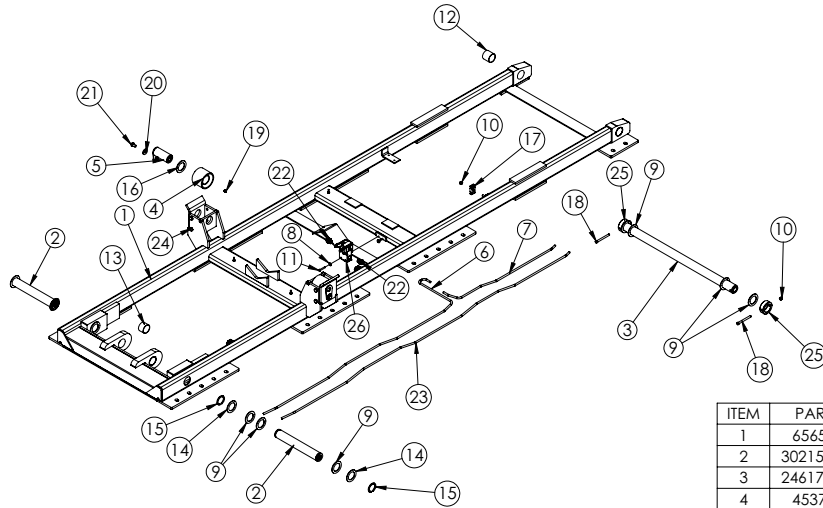

NOTE: ROLLERS 45373 TAPPER FACES TOWARD INSIDE

| ITEM | PART    | DESCRIPTION  | QTY. |
|------|---------|--|------|
| 1    | 65659   | BASE SLIDER 20S                                      | 1    |
| 2    | 30215CR | PIN 2.00X13.63 SR                                    | 2    |
| 3    | 24617CR | PIN 2.00X36.44                                       | 1    |
| 4    | 45373   | ROLLER 2.00X4.00X3.00 OUTSIDE SI60                   | 2    |
| 5    | 54522CR | PIN TEAR DROP 2.00X4.38 W/ZERK                       | 2    |
| 6    | 66582   | TUBE ASM 0.38X62.09 SLIDER20S JIB RETRACT VALVE YZ   | 1    |
| 7    | 54603   | TUBE ASM 0.38X32.60 SLIDER26 JIB RETRACT YZ          | 1    |
| 8    | 0340    | WASHER 0.25 USS FLAT                                 | 2    |
| 9    | 1546    | THRUST WASHER 2.01DIA UHMW .12THK                    | 10   |
| 10   | 0347    | NUT 0.38-16 HHGR5 NYLOC                              | 5    |
| 11   | 0332    | CAP SCR 0.25-20X1.75 HHGR5                           | 2    |
| 12   | 4381    | BUSHING 32DXR32 2.00X2.00 GARLOCK                    | 4    |
| 13   | 4380    | BUSHING 32DXR24 2.00X1.50 GARLOCK                    | 2    |
| 14   | 0377    | MACHY WASHER 2.00ID 14GA                             | 4    |
| 15   | 0108    | SNAP RING 2.00 7200-200                              | 4    |
| 16   | 0427    | MACHY WASHER 2.00ID 10GA                             | 2    |
| 17   | 8622    | CLAMP HOSE/TUBE AG-2                                 | 6    |
| 18   | C0953   | CAP SCR 0.38-16X4.00 HHGR5                           | 2    |
| 19   | c1592   | ZERK 1/8 NPT STRAIGHT                                | 2    |
| 20   | 0352    | WASHER 0.50 USS FLAT                                 | 2    |
| 21   | C0990   | CAP SCR 0.50-13X0.75 HHGR5                           | 2    |
| 22   | 57734   | FTG 8-6 MBSPP-MFS STRAIGHT                           | 2    |
| 23   | 66581   | TUBE ASM 0.38X93.46 SLIDER20S JIB EXTEND YZ          | 1    |
| 24   | 66945   | CAP SCR 0.50-13X0.50 PLASTIC - BLACK                 | 8    |
| 25   | 22764   | COLLAR 2.01X3.00X1.00 W/HOLE                         | 2    |
| 26   | 86130   | VALVE PLUNGER VILLA HYD NORMALLY CLOSED W/35 DEG ARM | 1    |

## Plunger Valve Assembly - PN 86130

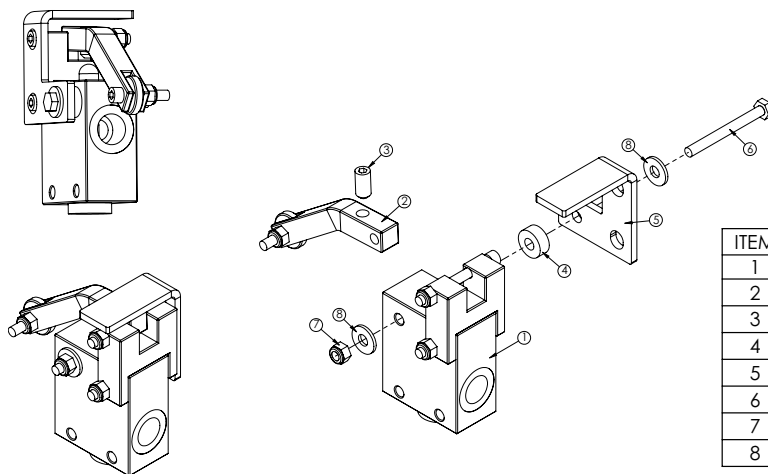

| ITEM | PART  | DESCRIPTION                             | QTY. |
|------|-------|---|------|
| 1    | 53853 | VALVE PLUNGER VILLA HYD NORMALLY CLOSED | 1    |
| 2    | 86126 | LEVER ARM ASM 35 DEG                    | 1    |
| 3    | 86161 | SET SCREW 0.38-16X0.75 W/ RED PATCH     | 1    |
| 4    | 60348 | COLLAR 0.31X0.75X0.31 UHMW              | 1    |
| 5    | 60470 | BRKT PLUNGER VILLA HYD VALVE            | 1    |
| 6    | 0339  | CAP SCR 0.25-20X2.50 HHGR5              | 1    |
| 7    | 0333  | NUT 0.25-20 HHGR5 NYLOC                 | 1    |
| 8    | 0340  | WASHER 0.25 USS FLAT                    | 2    |

# Base Assembly - PN 65658 continued...

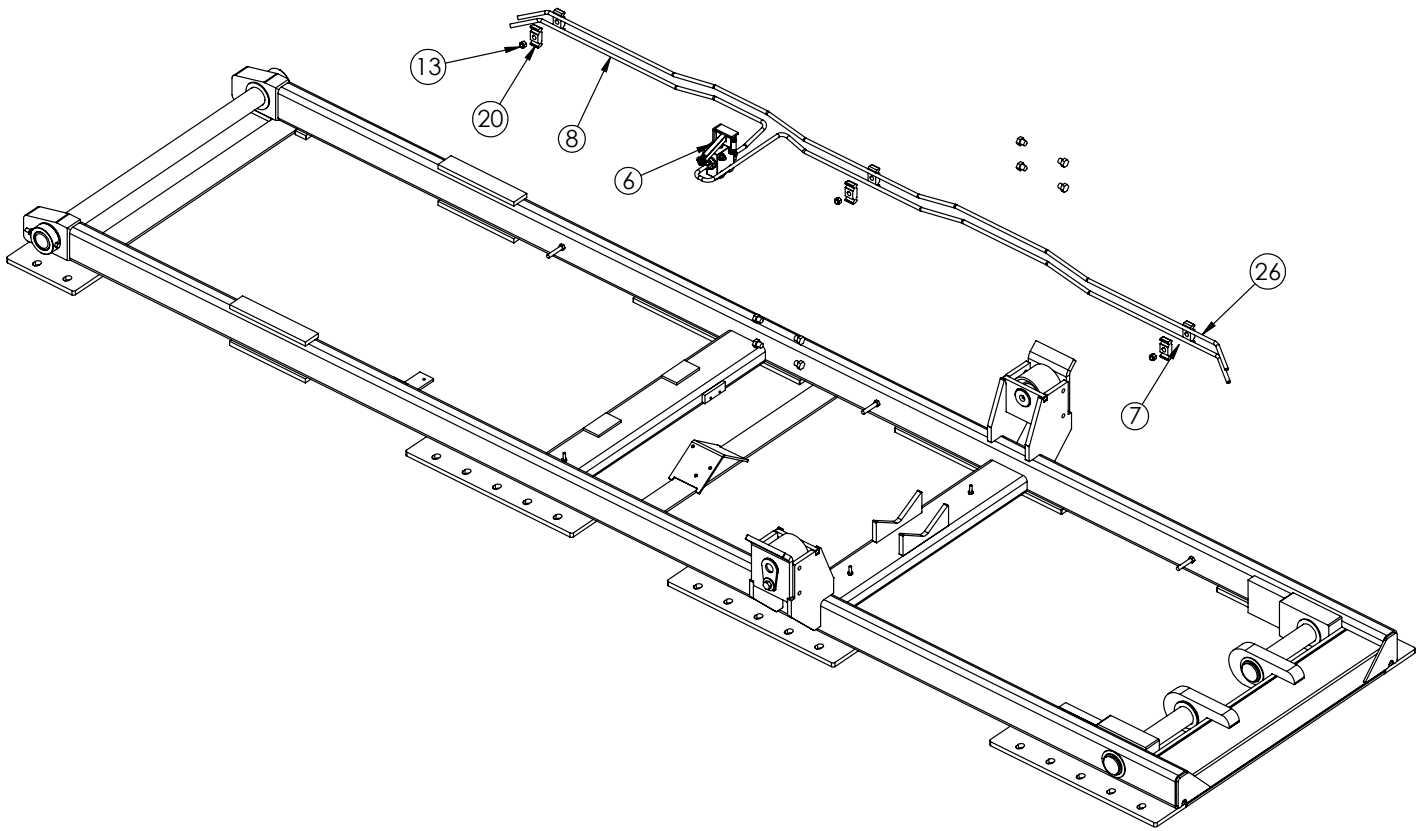

## PN 65658

| ITEM | PART  | DESCRIPTION  | QTY. |
|------|-------|--|------|
| 6    | 53853 | VALVE PLUNGER VILLA HYD NORMALLY CLOSED            | 1    |
| 7    | 66582 | TUBE ASM 0.38X62.09 SLIDER20S JIB RETRACT VALVE YZ | 1    |
| 8    | 54603 | TUBE ASM 0.38X32.60 SLIDER26 JIB RETRACT YZ        | 1    |
| 13   | 0347  | NUT 0.38-16 HHGR5 NYLOC                            | 5    |
| 20   | 8622  | CLAMP HOSE/TUBE AG-2                               | 6    |
| 26   | 66581 | TUBE ASM 0.38X93.46 SLIDER20S JIB EXTEND YZ        | 1    |



# Dump Assembly - PN 68957

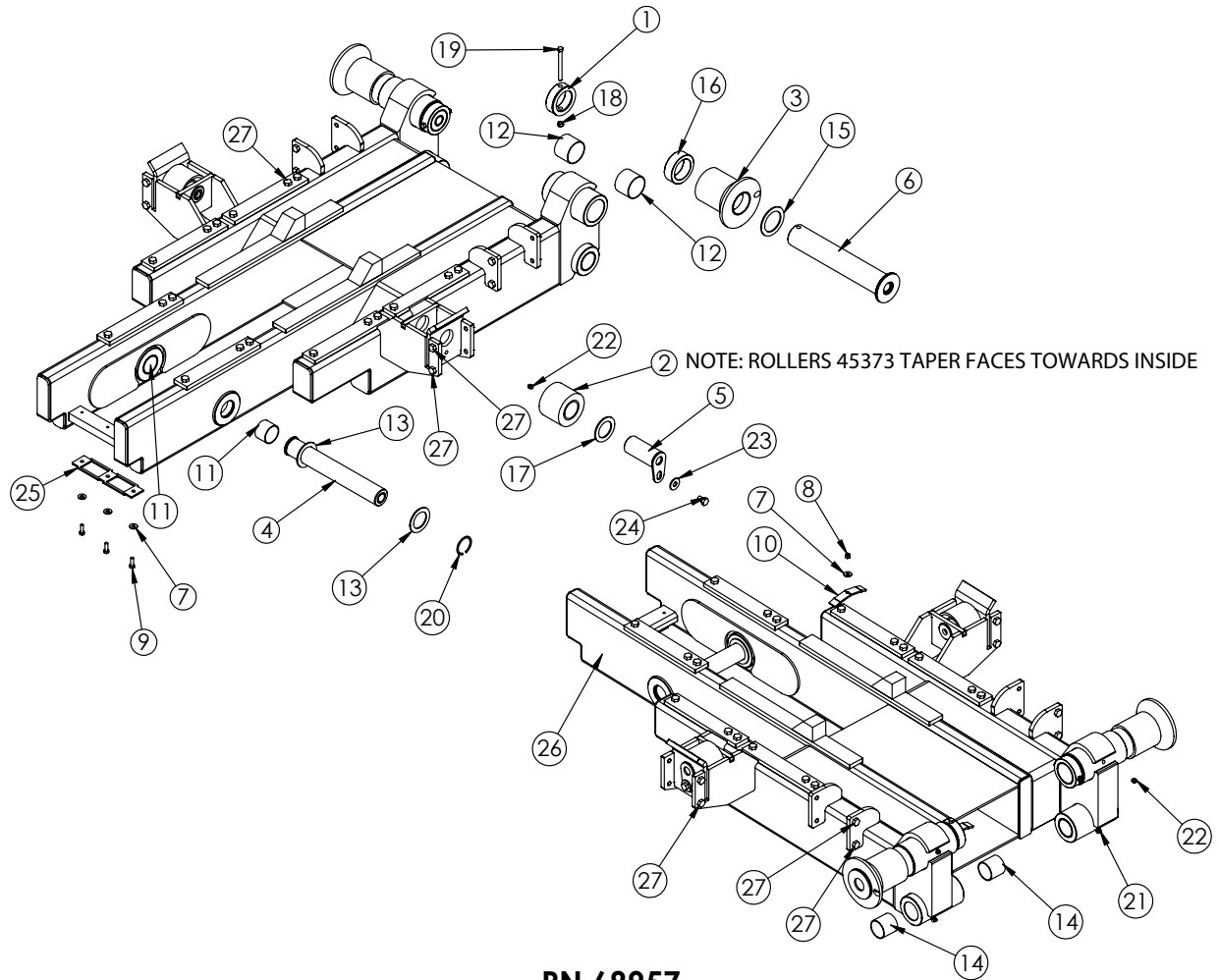

## PN 68957

| ITEM | PART    | DESCRIPTION                               | QTY. |
|------|---------|---|------|
| 1    | 23930PC | COLLAR 2.51X3.50X1.00                     | 2    |
| 2    | 45373   | ROLLER 2.00X4.00X3.00 OUTSIDE SI60        | 2    |
| 3    | 21496PC | ROLLER 2.50X4.00X3.81X6.00 POWDERCOAT YEL | 2    |
| 4    | 53737ZP | PIN 2.00X13.81                            | 1    |
| 5    | 54522ZP | PIN TEAR DROP 2.00X4.38 W/ZERK            | 2    |
| 6    | 54648ZP | PIN WLDMT 2.50X14.19                      | 2    |
| 7    | 0343    | WASHER 0.31 USS FLAT ZINC                 | 5    |
| 8    | 0342    | NUT 0.31-18 HHGR5 NYLOC                   | 2    |
| 9    | C0922   | CAP SCR 0.31-18X1.00 HHGR5                | 3    |
| 10   | 3381PC  | HOSE CLAMP BOLT ON 1210 CRANE             | 2    |
| 11   | 4380    | BUSHING 32DXR24 2.00X1.50 GARLOCK         | 2    |
| 12   | 0635    | BUSHING 40DXR32 GARLOCK                   | 4    |
| 13   | 1546    | THRUST WASHER 2.01DIA UHMW .12THK         | 2    |
| 14   | 4381    | BUSHING 32DXR32 2.00X2.00 GARLOCK         | 4    |
| 15   | 1547    | THRUST WASHER 2.51DIA UHMW .12THK         | 4    |
| 16   | 54649   | COLLAR 2.51X3.50X1.13 UHMW                | 2    |
| 17   | 0427    | MACHY WASHER 2.00ID 10GA                  | 2    |
| 18   | 0347    | NUT 0.38-16 HH NYLOC                      | 2    |
| 19   | C0953   | CAP SCR 0.38-16X4.00 HHGR5                | 2    |
| 20   | 2257    | SNAP RING INSIDE 2.00                     | 2    |
| 21   | C1597   | ZERK 1/8 NPT 90 DEG                       | 2    |
| 22   | C1592   | ZERK 1/8 NPT STRAIGHT                     | 4    |
| 23   | 0352    | WASHER 0.50 USS FLAT ZINC                 | 2    |
| 24   | C0990   | CAP SCR 0.50-13X0.75 HHGR5                | 2    |
| 25   | 57479PC | PLATE LATCH BAR SLIDER26                  | 1    |
| 26   | 68958   | DUMP SLIDER20S INSIDE/OUTSIDE LATCH       | 1    |
| 27   | 66945   | CAP SCR 0.50-13X0.50 PLASTIC - BLACK      | 34   |

NOTE: PORT RELIEF VDM8 2500 PSI PART NUMBER 26182  
TO BE PLACED IN THE EXTEND SIDE OF THE JIB VALVE SECTION

# Outside Latch Assembly - PN 55358 (Optional)

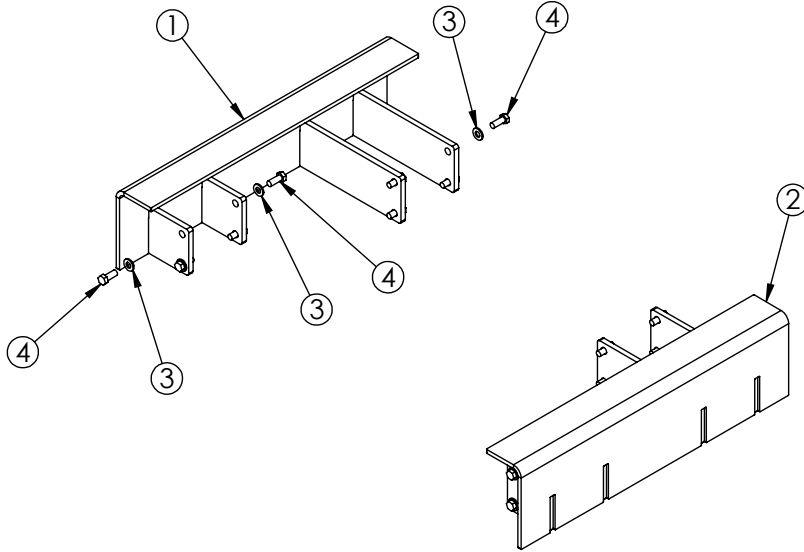

## PN 55358

| ITEM NO. | PART NUMBER | DESCRIPTION                     | QTY. |
|----------|-------------|---------------------------------|------|
| 1        | 54812       | LATCH WLDMT OUTSIDE CS BOLT ON  | 1    |
| 2        | 54816       | LATCH WLDMT OUTSIDE SS BOLT ON  | 1    |
| 3        | D0790       | WASHER 0.50 SAE FLAT YELLOW GR8 | 16   |
| 4        | 10666       | CAP SCR 0.50-13X1.25 HHGR8      | 16   |

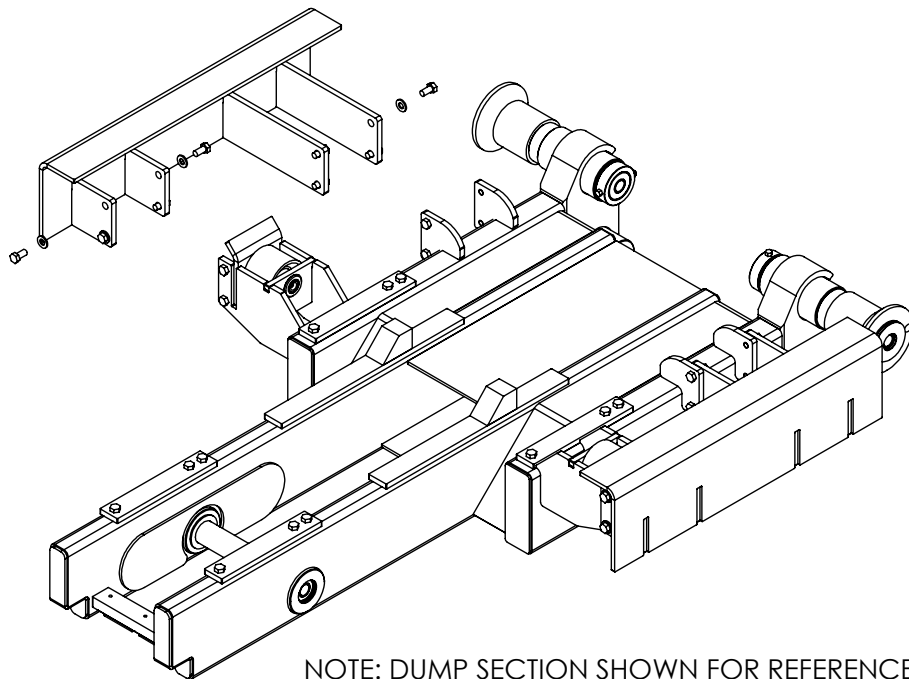

# Inside Latch Assembly - PN 54216 (Optional)

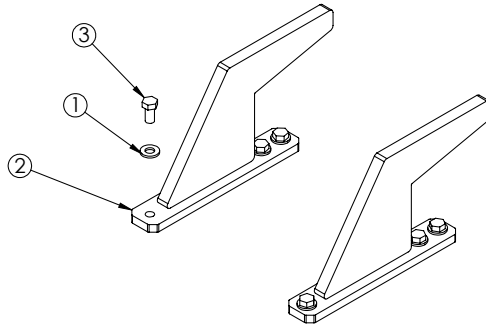

## PN 54216

| ITEM | PART  | DESCRIPTION                     | QTY. |
|------|-------|---------------------------------|------|
| 1    | D0790 | WASHER 0.50 SAE FLAT YELLOW GR8 | 6    |
| 2    | 54740 | LATCH INSIDE BOLT ON            | 2    |
| 3    | 10172 | CAP SCR 0.50-13X1.00 HHGR8      | 6    |

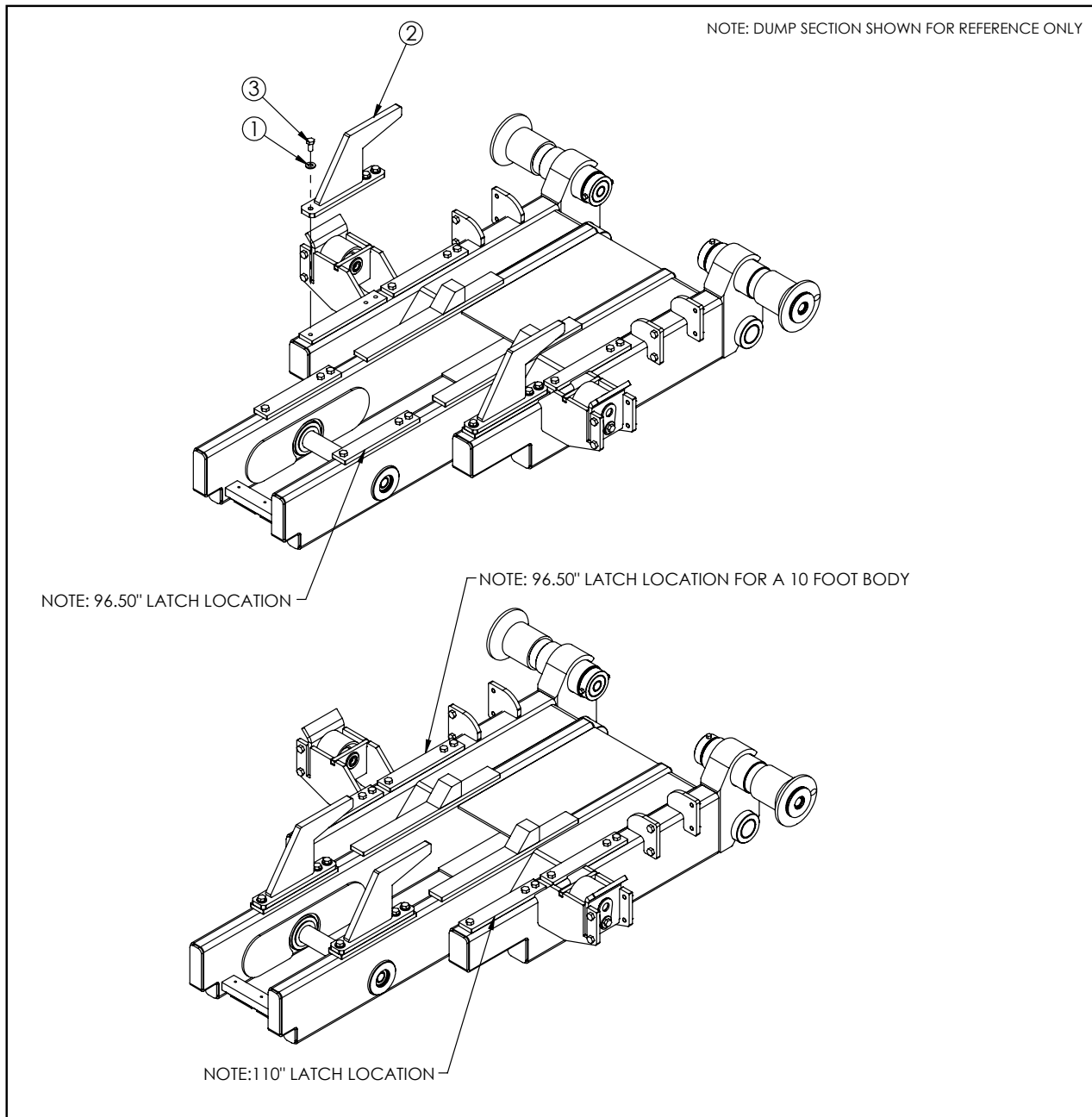

# Secondary Assembly - PN 66661

## PN 66661

| ITEM | PART    | DESCRIPTION                            | QTY. |
|------|---------|--|------|
| 1    | 66702   | SECONDARY SLIDER 20S                   | 1    |
| 2    | 0246    | SNAP RING-ID 7200.150                  | 2    |
| 3    | 30961CR | PIN 1.50X9.25 SR                       | 1    |
| 4    | 0376    | MACHY WASHER 1.50ID 14GA               | 6    |
| 5    | 30962   | WEAR PAD 2.50X1.25                     | 8    |
| 6    | D0419   | THRUST WASHER                          | 2    |
| 7    | 54222   | PLATE WEAR PAD CAP SLIDER 26           | 8    |
| 8    | 4381    | BUSHING 32DXR32.2.00X2.00 GARLOCK      | 2    |
| 9    | C1592   | ZERK 1/8 NPT STRAIGHT                  | 1    |
| 10   | 80982   | DUMP LATCH ASM SLIDER26                | 1    |
| 11   | 54819   | FORMED PLATE COVER SEC SLIDER 26       | 1    |
| 12   | 1547    | THRUST WASHER 2.51DIA UHMW .12THK      | 4    |
| 13   | 0488    | CAP SCR 0.31-18X2.00 HHGR5             | 1    |
| 14   | 0484    | CAP SCR 0.31-18X0.50 HHGR5             | 4    |
| 15   | 0343    | WASHER 0.31 USS FLAT                   | 4    |
| 16   | 54817   | SPRING 1.00ODX0.125X4.50               | 1    |
| 17   | 6538    | WASHER 1.00 SAE FLAT YELLOW GR8        | 2    |
| 18   | 0356    | CAP SCR 0.63-11X1.50 HHGR8             | 2    |
| 19   | C5902   | WASHER 0.63 SAE FLAT YELLOW GR8        | 34   |
| 20   | 0164CR  | PIN 1.00X8.38 SR                       | 1    |
| 21   | 0424    | MACHY WASHER 1.00ID 10GA               | 2    |
| 22   | C3397   | SET SCREW 0.38-16X0.38 W/ RED PATCH    | 1    |
| 23   | 66826   | CYLINDER ASM DUAL SLIDER 20S           | 1    |
| 24   | 0342    | NUT 0.31-18 HHGR5 NYLOC                | 1    |
| 25   | 8455    | PIN CAP 0.69X3.50X0.19 YZ              | 2    |
| 26   | 66839   | CAP SCR 0.63-11X1.25 HHGR8 W/RED PATCH | 32   |
| 27   | 0426    | MACHY WASHER 1.50ID 10GA               | 4    |

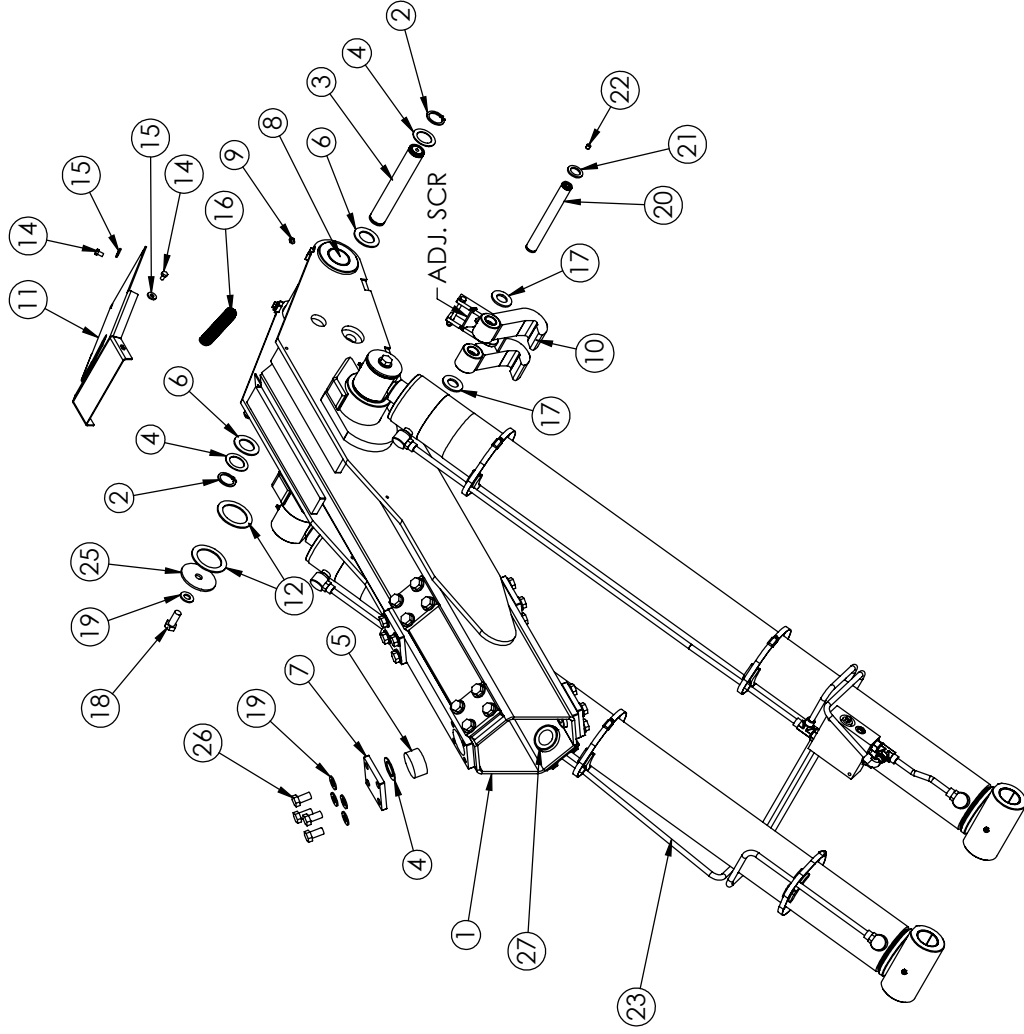

### NOTE: FOR SHIMMING WEAR PADS

1. PLACE 1 OF PART NUMBER 0376 BEHIND THE 4 WEAR PADS ON THE TOP
2. PLACE 1 OF PART NUMBER 0426 BEHIND THE 4 WEAR PADS ON THE BOTTOM.

# Dump Latch Assembly - PN 80982

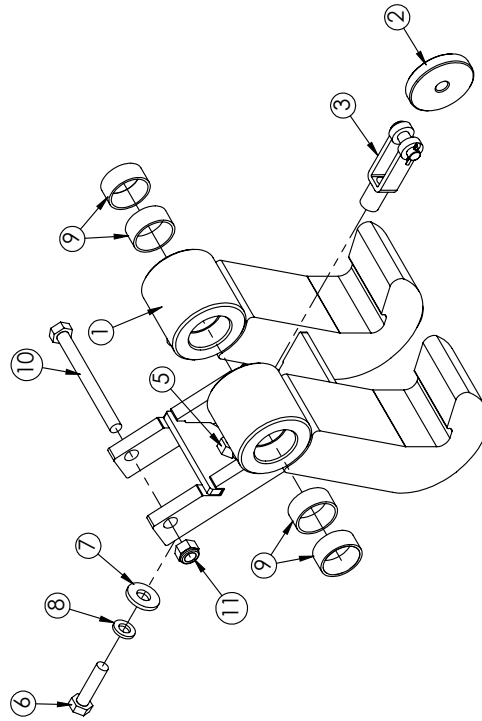
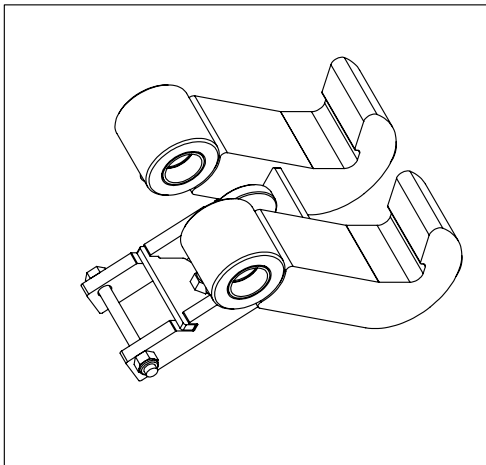

| ITEM | PART   | DESCRIPTION                       | QTY. |
|------|--------|-----------------------------------|------|
| 1    | 87186  | DUMP LATCH W/DMT SLIDER 26        | 1    |
| 2    | 70118  | ROLLER 1.75ODX0.33IDX0.31W        | 1    |
| 3    | 70056  | CLEVIS ROD END 0.31X2.25 1.583K23 | 1    |
| 4    | c 1592 | ZERK 1/8 NPT STRAIGHT             | 2    |
| 5    | 0534   | NUT 0.31-18 HHGR5                 | 1    |
| 6    | 0485   | CAP SCR 0.31-18X1.25 HHGR5        | 1    |
| 7    | 0343   | WASHER 0.31 USS FLAT              | 1    |
| 8    | 0522   | WASHER 0.31 LOCK                  | 1    |
| 9    | 20362  | BUSHING BPC16DXR08 1.00X.50       | 4    |
| 10   | 12178  | CAP SCR 0.31-18X3.25 HHGR5        | 1    |
| 11   | 12520  | NUT 0.31-18 HH NYLOC SS           | 1    |

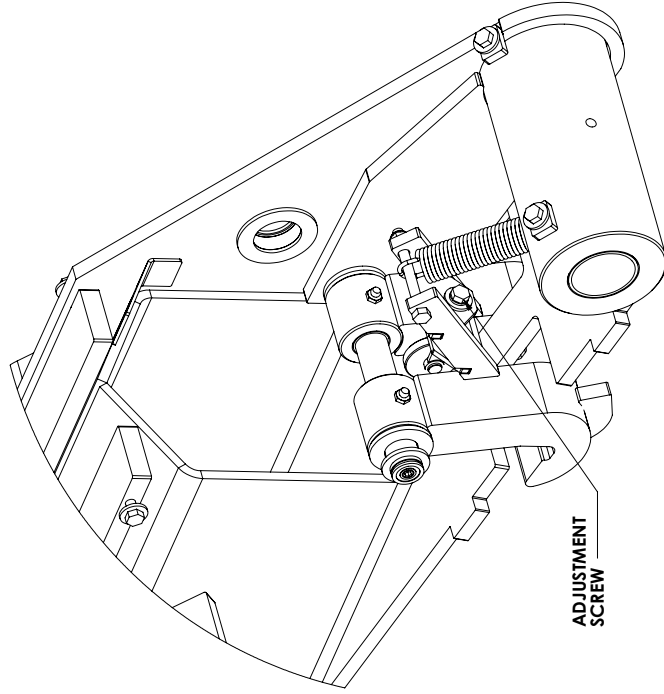

### NOTE: FOR SETTING THE ADJUSTMENT SCREW

1. THE TAB ON THE BACK OF THE JIB PUSHES ON THE SCREW TO RELEASE THE LATCHES
2. THE SCREW SHOULD BE SET SO THAT WHEN THE JIB IS FULLY RETRACTED THE LATCHES CLEAR THE DUMP LATCH BAR AND DO NOT COME IN CONTACT WITH THE BOTTOM SECONDARY PLATE

# Main Cylinder Assembly - PN 66826

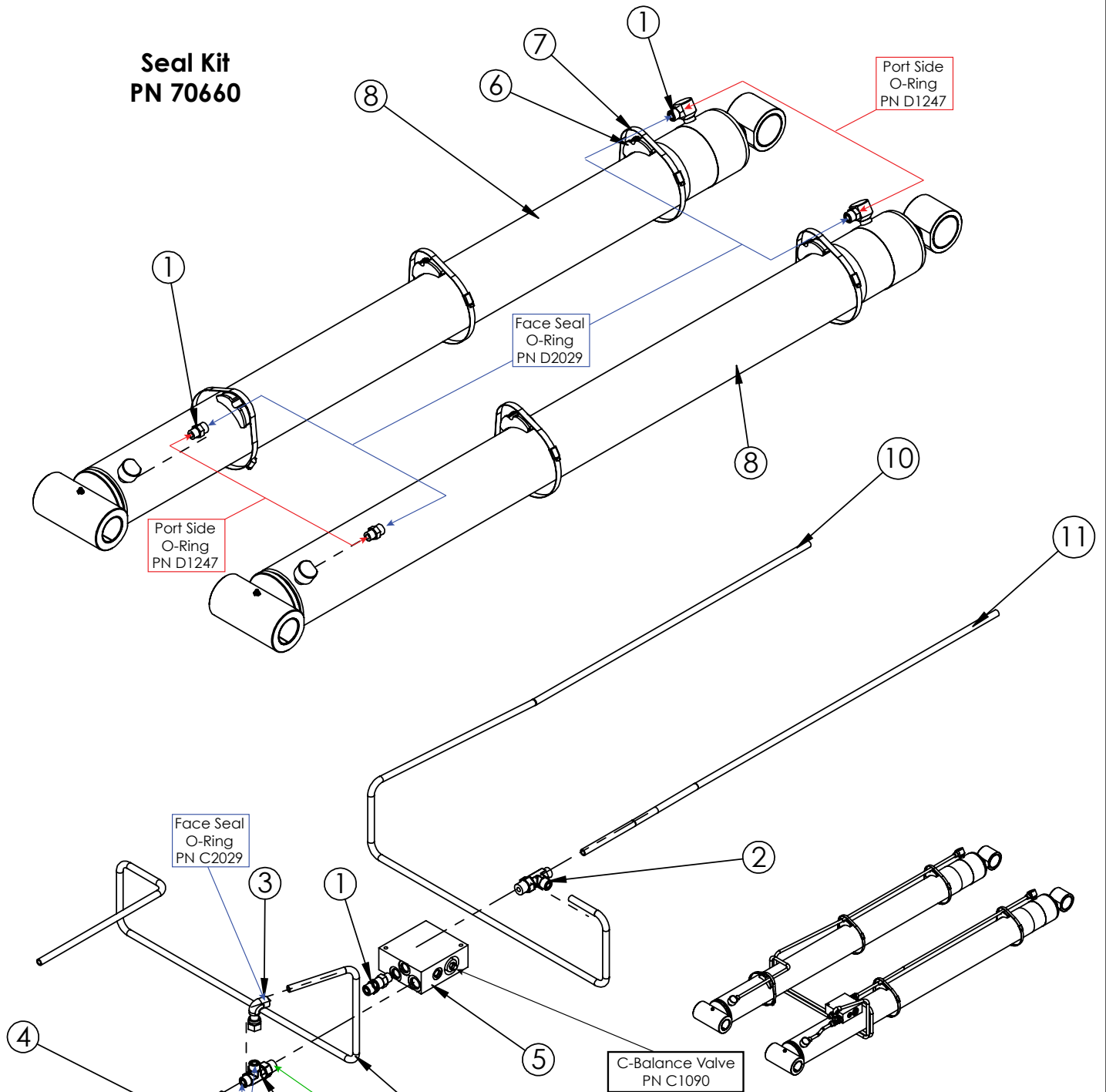

## PN 66826

| ITEM | PART  | DESCRIPTION                                  | QTY. |
|------|-------|--|------|
| 1    | 1554  | FTG 8-8 MFS-MORB STRAIGHT                    | 6    |
| 2    | 37179 | FTG 8-10-8 MFS-MAORB-MFS TEE                 | 2    |
| 3    | C2376 | FTG 8-8 MFS-FFSS 90                          | 1    |
| 4    | 53847 | TUBE ASM 0.50X5.75 SLIDER 26 SS EXTEND YZ    | 1    |
| 5    | 15995 | MANIFOLD ASM DUAL T2A 5000PSI                | 1    |
| 6    | 18701 | CLAMP PORT TUBE ZR518                        | 5    |
| 7    | 19369 | HOSE CLAMP 4.13-7.00 5416K38                 | 5    |
| 8    | 65957 | CYLINDER 4.50X59.50                          | 2    |
| 9    | 66942 | TUBE ASM 0.50X25.64 SLIDER 20S CS EXTEND YZ  | 1    |
| 10   | 66943 | TUBE ASM 0.50X45.42 SLIDER 20S CS RETRACT YZ | 1    |
| 11   | 66941 | TUBE ASM 0.50X44.21 SLIDER 20S SS RETRACT YZ | 1    |

# Jib Assembly (35.63" Hook Height) - PN 66657

Note: Use Stellar® Boom Lube (PN 44512) on sliding boom surfaces.

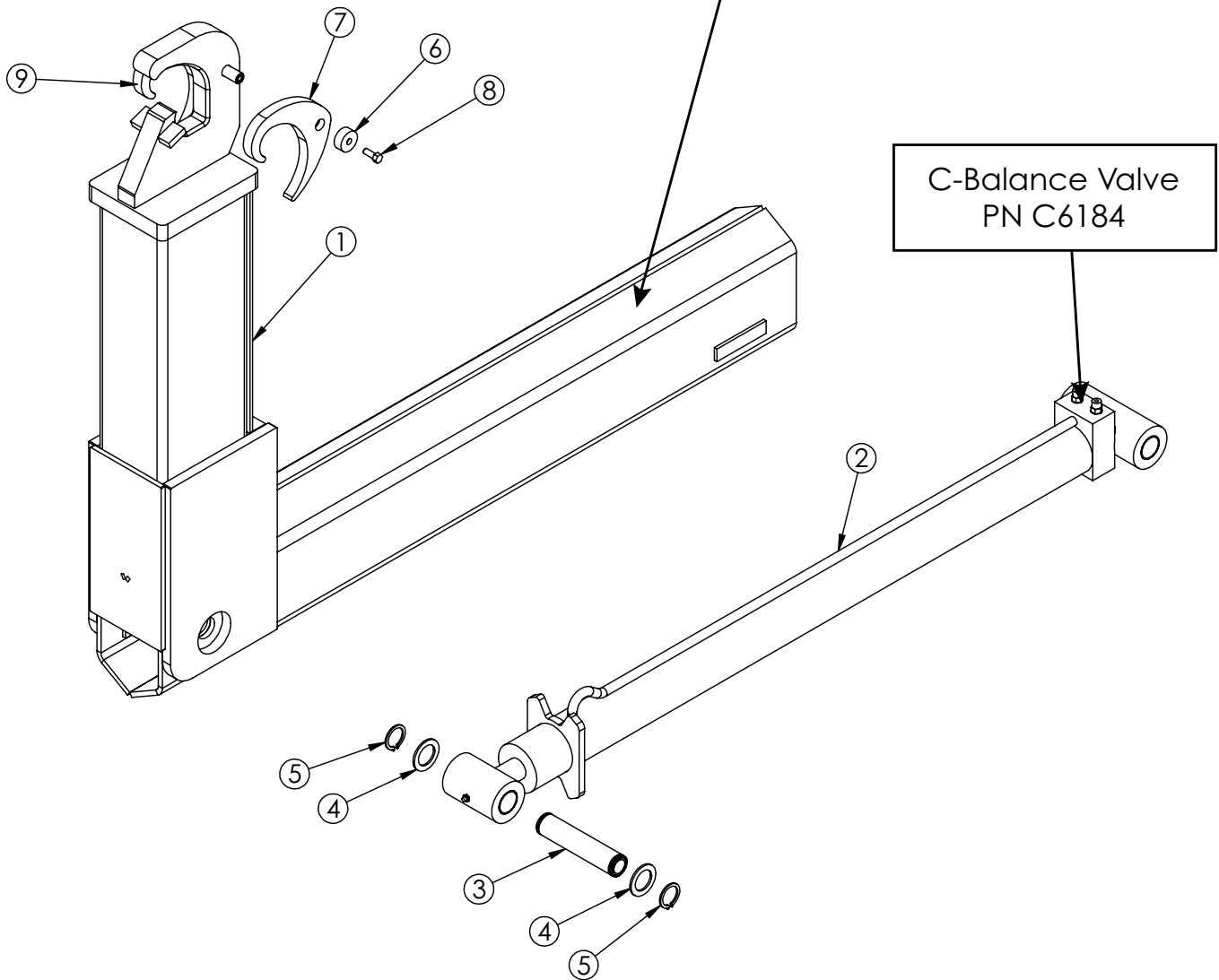

## PN 66657

| ITEM | PART    | DESCRIPTION              | QTY. |
|------|---------|--------------------------|------|
| 1    | 66658   | JIB SLIDER20S 36HH SBH   | 1    |
| 2    | 66822   | CYLINDER ASM 3.00X30.00  | 1    |
| 3    | 28021ZP | PIN 1.50X6.88 SR         | 1    |
| 4    | 0426    | MACHY WASHER 1.50ID 10GA | 2    |
| 5    | 0246    | SNAP RING ID 7200 150    | 2    |
| 6    | 14672   | PIN CAP 0.44X1.50X0.63   | 2    |
| 7    | 73543   | LATCH SLIDER20S SS       | 1    |
| 8    | 9714    | CAP SCR 0.38-16X1.00 SS  | 2    |
| 9    | 73542   | LATCH SLIDER20S CS       | 1    |

# Jib Assembly (54" Hook Height) - PN 68298

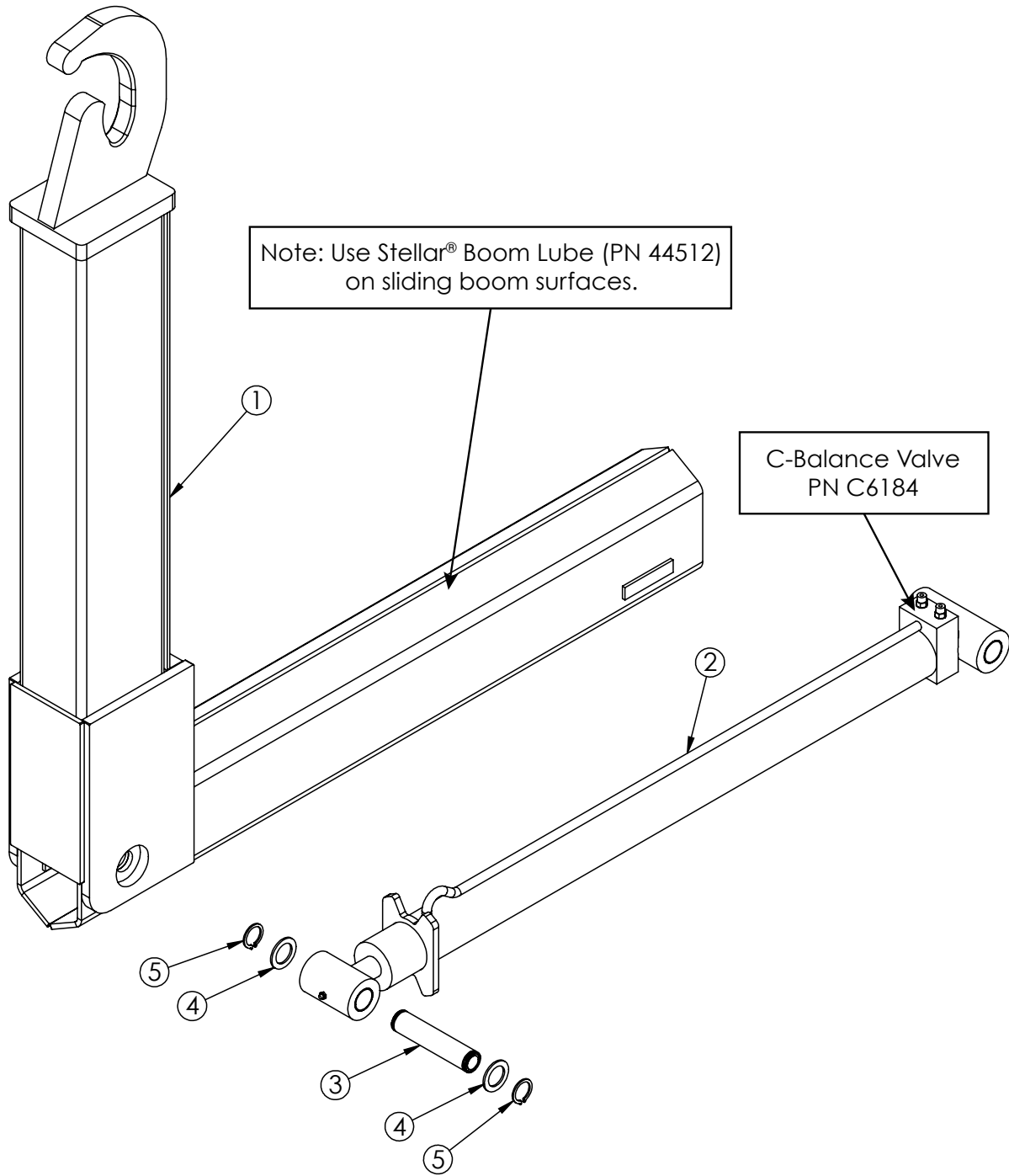

## PN 68298

| ITEM | PART    | DESCRIPTION              | QTY. |
|------|---------|--------------------------|------|
| 1    | 68299   | JIB SLIDER20S 54HH SBH   | 1    |
| 2    | 66822   | CYLINDER ASM 3.00X30.00  | 1    |
| 3    | 28021ZP | PIN 1.50X6.88 SR         | 1    |
| 4    | 0426    | MACHY WASHER 1.50ID 10GA | 2    |
| 5    | 0246    | SNAP RING ID 7200 150    | 2    |



# Jib Assembly (35.63/54" Hook Height) - PN 66583

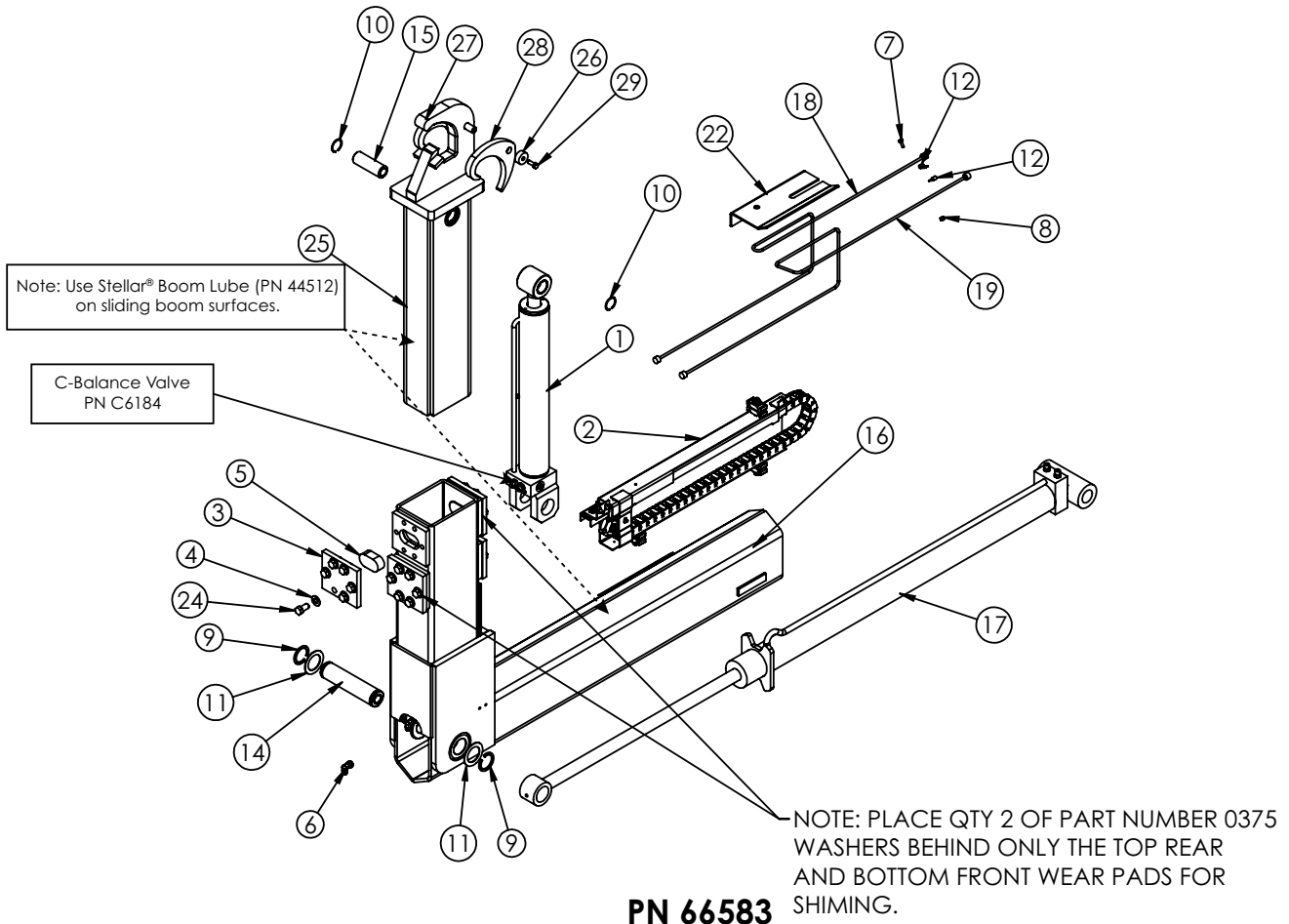

## PN 66583

| ITEM | PART    | DESCRIPTION  | QTY |
|------|---------|--|-----|
| 1    | 54529   | CYLINDER ASM 3.00X17.88                            | 1   |
| 2    | 54213   | HOSE TRACK ASM SLIDER 26                           | 1   |
| 3    | 43513PC | PLATE WEAR PAD COVER SLIDER34 JIB                  | 4   |
| 4    | C5902   | WASHER 0.63 SAE FLAT YELLOW GR8                    | 24  |
| 5    | 42448   | WEAR PAD A2 HYD JIB                                | 4   |
| 6    | D1314   | FTG 4-4 MFS-FFSS 90                                | 2   |
| 7    | 0479    | CAP SCR 0.25-20X0.75 HHGR5                         | 3   |
| 8    | 0333    | NUT 0.25-20 HHGR5 NYLOC                            | 6   |
| 9    | 0108    | SNAP RING 2.00 7200-200                            | 2   |
| 10   | 54129   | SNAP RING INSIDE 1.50                              | 2   |
| 11   | 0377    | MACHY WASHER 2.00ID 14GA                           | 2   |
| 12   | C5606   | CLAMP 0.25 BLK VINYL                               | 10  |
| 13   | 0375    | MACHY WASHER 0.75ID 14GA                           | 4   |
| 14   | 47847ZP | PIN 2.00X8.44 SR                                   | 1   |
| 15   | 54130ZP | PIN 1.50X4.31                                      | 1   |
| 16   | 66584   | JIB HYD SLIDER 20S 36/54HH                         | 1   |
| 17   | 66588   | CYLINDER ASM 3.00X30.00 SHORT BOSS                 | 1   |
| 18   | 66608   | TUBE ASM 0.25X43.38 SLIDER20S JIB HH SMALL BEND YZ | 1   |
| 19   | 66607   | TUBE ASM 0.25X43.38 SLIDER20S JIB HH LARGE BEND YZ | 1   |
| 20   | 66609   | TUBE ASM 0.25X65.65 SLIDER20S JIB HH YZ            | 1   |
| 21   | 66610   | TUBE ASM 0.25X65.19 SLIDER20S JIB HH YZ            | 1   |
| 22   | 66944PC | PLATE 0.19X13.00 COVER SLIDER 20S                  | 1   |
| 23   | 17162   | WEATHERSTRIP RIBBED 0.38X0.13                      | 1   |
| 24   | 66839   | CAP SCR 0.63-11X1.25 HHGR8 ZY W/RED PATCH          | 24  |
| 25   | 73611   | JIB TOP SLIDER 20S HYD ADJUST 36/54HH              | 1   |
| 26   | 14672   | PIN CAP 0.44X1.50X0.63                             | 2   |
| 27   | 73542   | LATCH SLIDER20S CS                                 | 1   |
| 28   | 73543   | LATCH SLIDER20S SS                                 | 1   |
| 29   | 9714    | CAP SCR 0.38-16X1.00 SS                            | 2   |

ITEMS NOT SHOWN: C2031 (2)

# Jib Assembly (35.63/54" Hook Height) - PN 66583 Continued...

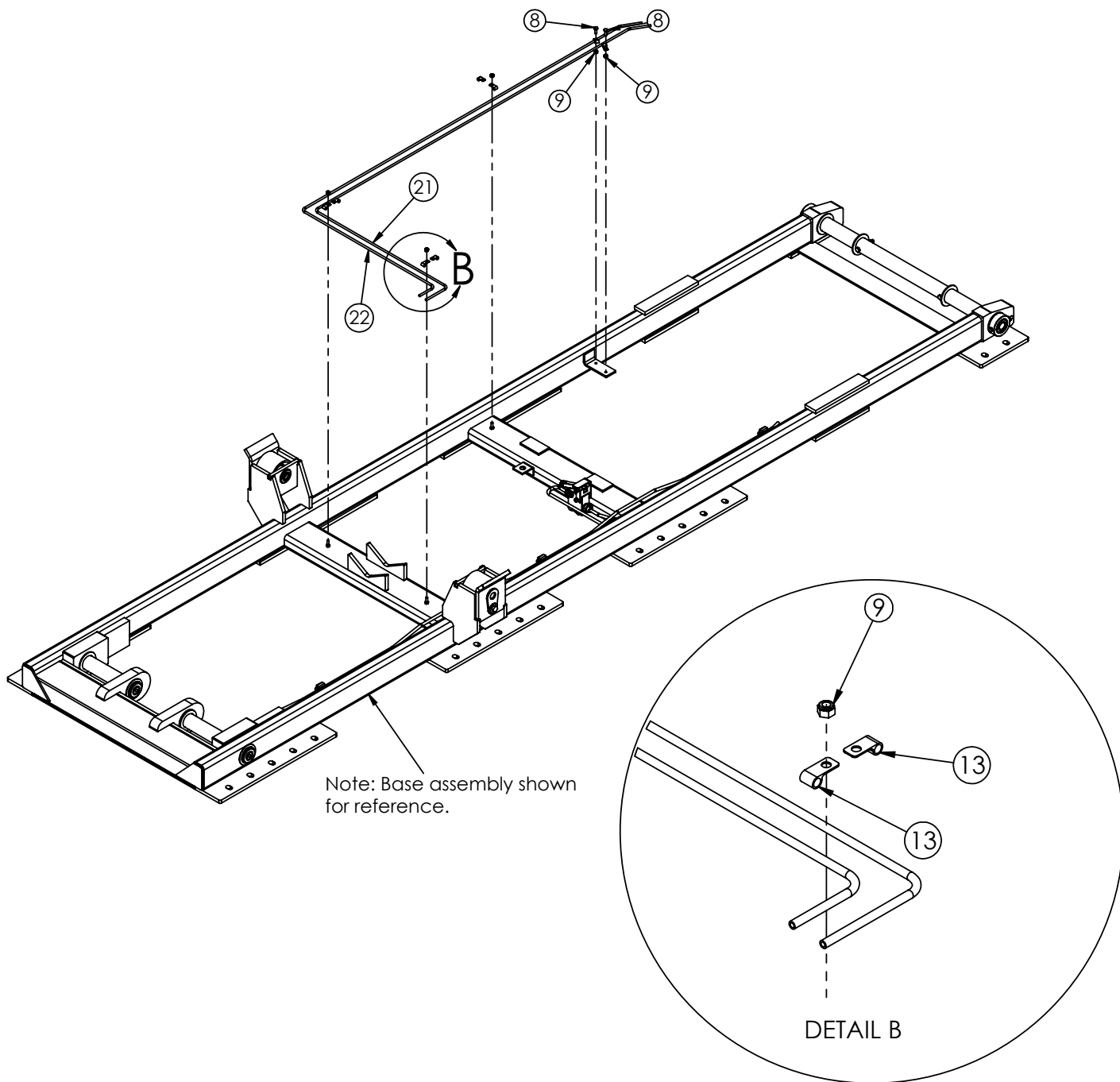

| ITEM | PART  | DESCRIPTION                             | QTY |
|------|-------|---|-----|
| 8    | 0479  | CAP SCR 0.25-20X0.75 HHGR5              | 3   |
| 9    | 0333  | NUT 0.25-20 HHGR5 NYLOC                 | 6   |
| 13   | C5606 | CLAMP 0.25 BLK VINYL                    | 10  |
| 21   | 66609 | TUBE ASM 0.25X65.65 SLIDER20S JIB HH YZ | 1   |
| 22   | 66610 | TUBE ASM 0.25X65.19 SLIDER20S JIB HH YZ | 1   |

# Hose Track - PN 54213

NOTE: WHEN PLACING THE HOSES (84617) FROM KIT (84289) INTO THE HOSE TRACK (54193) LEAVE EQUAL LENGTHS OF HOSE OUT EACH END OF THE HOSE TRACK, ABOUT 16 INCHES.

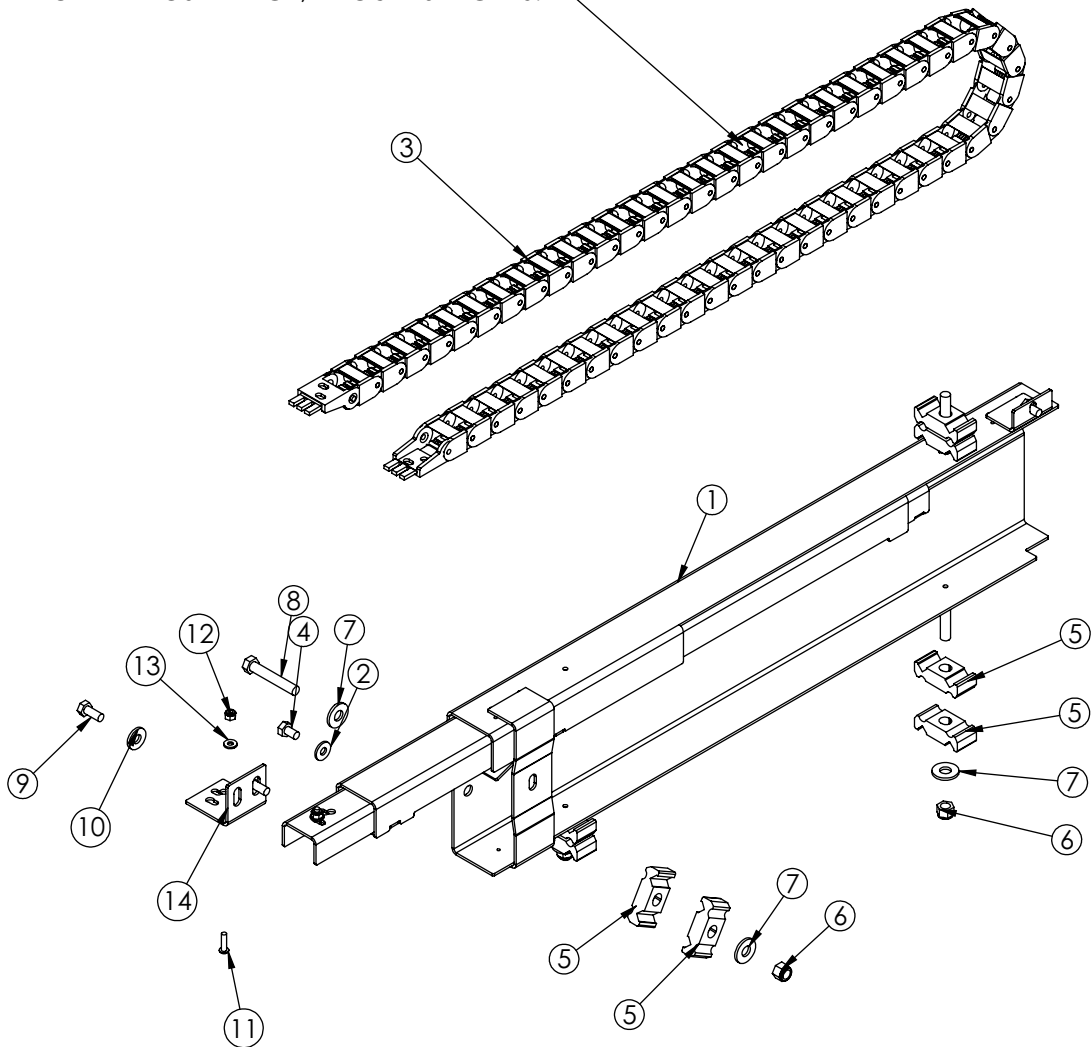

## PN 54213

| ITEM | PART  | DESCRIPTION                      | QTY. |
|------|-------|----------------------------------|------|
| 1    | 54131 | HOSE TRACK WLDMT SLIDER26        | 1    |
| 2    | 0340  | WASHER 0.25 USS FLAT             | 2    |
| 3    | 54193 | HOSE TRACK SLIDER 26             | 1    |
| 4    | 0484  | CAP SCR 0.31-18X0.50 HHGR5       | 2    |
| 5    | 8622  | CLAMP HOSE/TUBE AG-2             | 8    |
| 6    | 0347  | NUT 0.38-16 HHGR5 NYLOC          | 3    |
| 7    | 0346  | WASHER 0.38 USS FLAT             | 4    |
| 8    | C0946 | CAP SCR 0.38-16X2.25 HHGR5       | 1    |
| 9    | 0420  | CAP SCR 0.31-18X0.75 HHGR5       | 2    |
| 10   | 0343  | WASHER 0.31 USS FLAT             | 2    |
| 11   | D0894 | CAP SCR #10-24X0.75 BTNHD SS     | 4    |
| 12   | C4956 | NUT #10-24 HH NYLOC SS           | 4    |
| 13   | D0178 | WASHER #10 SAE FLAT              | 4    |
| 14   | 54214 | ANGLE FORMED 0.63X1.50X12GAX3.00 | 1    |

# Slider20-S Cylinder Assemblies

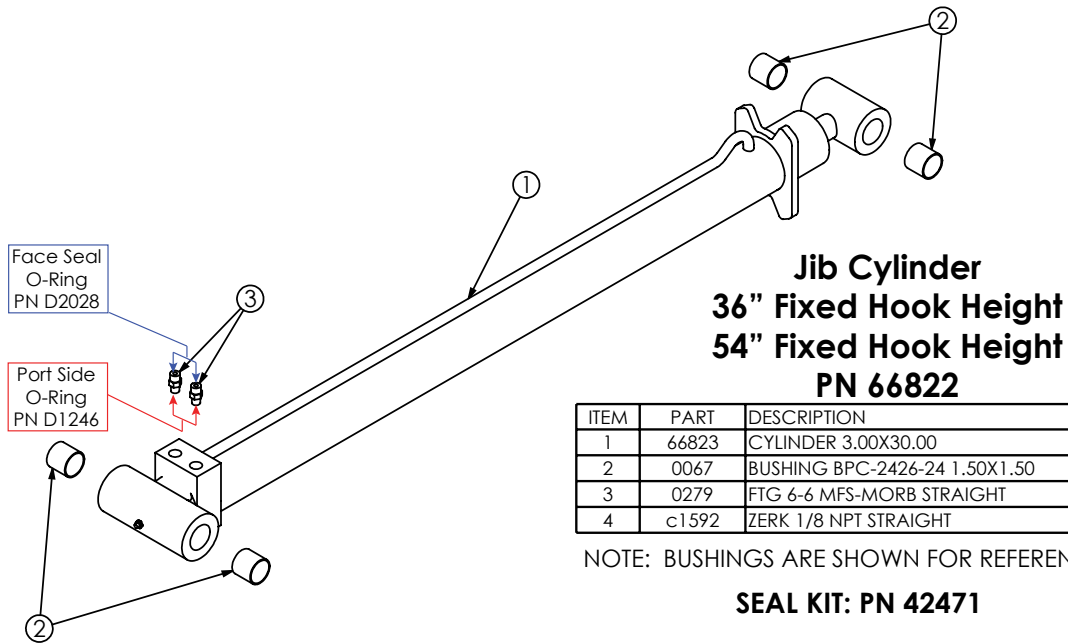

**Jib Cylinder**  
**36" Fixed Hook Height**  
**54" Fixed Hook Height**  
**PN 66822**

| ITEM | PART  | DESCRIPTION                   | QTY |
|------|-------|-------------------------------|-----|
| 1    | 66823 | CYLINDER 3.00X30.00           | 1   |
| 2    | 0067  | BUSHING BPC-2426-24 1.50X1.50 | 4   |
| 3    | 0279  | FTG 6-6 MFS-MORB STRAIGHT     | 2   |
| 4    | c1592 | ZERK 1/8 NPT STRAIGHT         | 2   |

NOTE: BUSHINGS ARE SHOWN FOR REFERENCE ONLY.

**SEAL KIT: PN 42471**

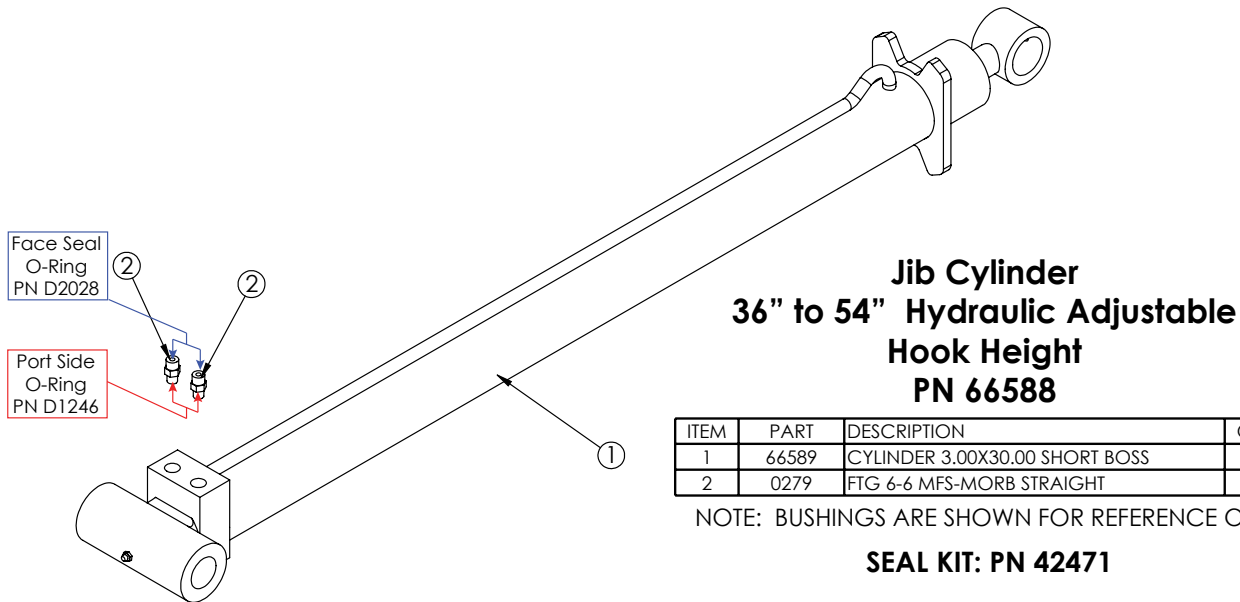

**Jib Cylinder**  
**36" to 54" Hydraulic Adjustable**  
**Hook Height**  
**PN 66588**

| ITEM | PART  | DESCRIPTION                    | QTY. |
|------|-------|--------------------------------|------|
| 1    | 66589 | CYLINDER 3.00X30.00 SHORT BOSS | 1    |
| 2    | 0279  | FTG 6-6 MFS-MORB STRAIGHT      | 2    |

NOTE: BUSHINGS ARE SHOWN FOR REFERENCE ONLY.

**SEAL KIT: PN 42471**

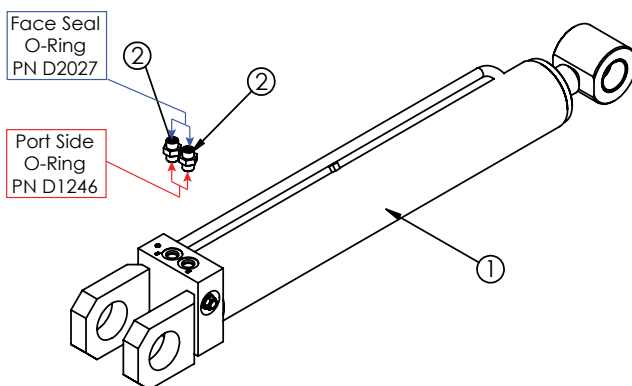

**Tilt Cylinder**  
**36" to 54" Hydraulic Adjustable**  
**Hook Height**  
**PN 54529**

| ITEM | PART  | DESCRIPTION               | QTY. |
|------|-------|---------------------------|------|
| 1    | 54521 | CYLINDER 3.00X17.88       | 1    |
| 2    | C4922 | FTG 4-6 MFS-MORB STRAIGHT | 2    |

NOTE: BUSHINGS ARE SHOWN FOR REFERENCE ONLY.

**SEAL KIT: PN 42471**

# Toolbox Assembly - PN 8480

PN 8480

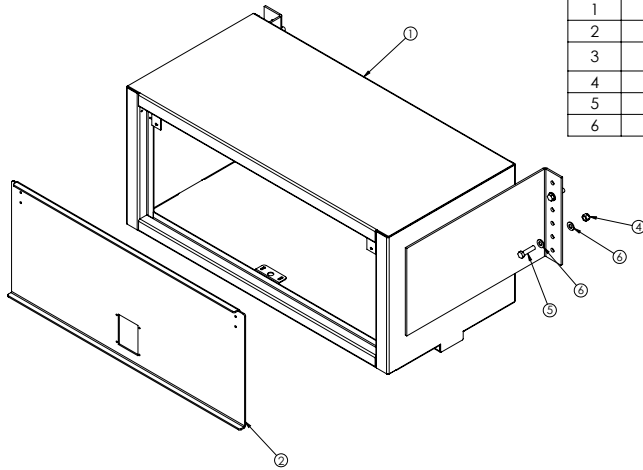

| ITEM | PART  | DESCRIPTION                                | QTY. |
|------|-------|--|------|
| 1    | 66791 | UBTB WLDMT OH 20X45X22 W/MOUNTS            | 1    |
| 2    | 7193  | DOOR AL OH 17.13X40.00                     | 1    |
| 3    | 10638 | HARDWARE ASM OH DOOR NOT SHOWN (NOT SHOWN) | 1    |
| 4    | 5468  | NUT 0.50-13 HHGR8 NYLOC                    | 4    |
| 5    | 8833  | CAP SCR 0.50-13X2.00 HHGR8                 | 4    |
| 6    | D0790 | WASHER 0.50 SAE FLAT YELLOW GR8            | 8    |

NOTE: ITEMS NOT SHOWN:  
C5976 (8 FT) WEATHERSTRIP  
70174 OH DOOR STOP KIT

# Toolbox Assembly - PN 10401

PN 10401

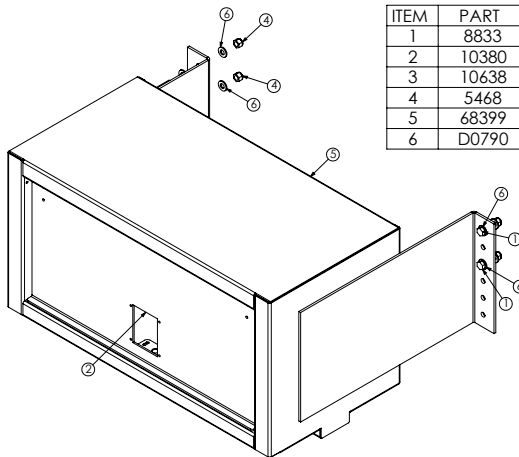

| ITEM | PART  | DESCRIPTION                                | QTY. |
|------|-------|--|------|
| 1    | 8833  | CAP SCR 0.50-13X2.00 HHGR8                 | 4    |
| 2    | 10380 | DOOR AL OH 15.19X31.00                     | 1    |
| 3    | 10638 | HARDWARE ASM OH DOOR NOT SHOWN (NOT SHOWN) | 1    |
| 4    | 5468  | NUT 0.50-13 HHGR8 NYLOC                    | 4    |
| 5    | 68399 | UBTB WLDMT OH OH 18X36X18 W/MOUNTS TAB     | 1    |
| 6    | D0790 | WASHER 0.50 SAE FLAT YELLOW GR8            | 8    |

ITEMS NOT SHOWN:  
C5976 (5 FT) WEATHERSTRIP  
70174 OH DOOR STOP KIT

# Toolbox Assembly - PN 10402

PN 10402

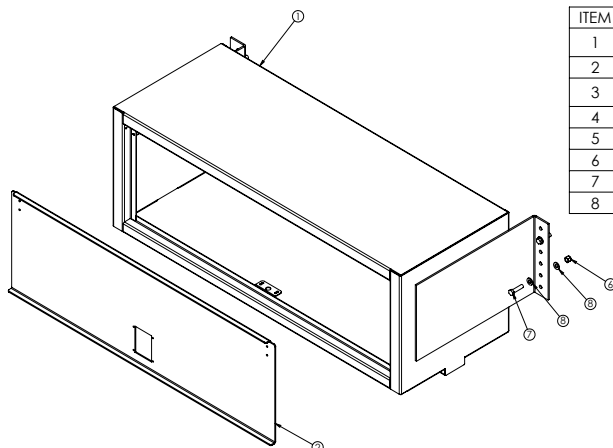

| ITEM | PART  | DESCRIPTION                                | QTY. |
|------|-------|--|------|
| 1    | 68604 | UBTB WLDMT OH 20X58X22 W/MOUNTS TAB        | 1    |
| 2    | 10427 | DOOR AL OH 17.19X53.00                     | 1    |
| 3    | 10638 | HARDWARE ASM OH DOOR NOT SHOWN (NOT SHOWN) | 1    |
| 4    | 0479  | CAP SCR 0.25-20X0.75 HHGR5                 | 2    |
| 5    | 0333  | NUT 0.25-20 HHGR5 NYLOC                    | 2    |
| 6    | 5468  | NUT 0.50-13 HHGR8 NYLOC                    | 4    |
| 7    | 8833  | CAP SCR 0.50-13X2.00 HHGR8                 | 4    |
| 8    | D0790 | WASHER 0.50 SAE FLAT YELLOW GR8            | 8    |

ITEMS NOT SHOWN:  
C5976 (8 FT) WEATHERSTRIP  
70174 OH DOOR STOP KIT



Subject to Change without Notification.  
© 2016 Stellar Industries, Inc.